

Dividends Horizon® Laminate/Veneer Tiles

Monolithic and tiled skins for raceway and open base

1. Attach clips with two (2) screws each. Always orient clips to face outward as shown in **Detail A**.

Note: No clips are required along the bottom edge of the lowest tile on the panel frame (at the base).

2. See page 2 for instructions on top clips.
3. For sizes requiring side clips in the middle position, only one clip is required per side.
4. All screws must be fully seated.

continued...

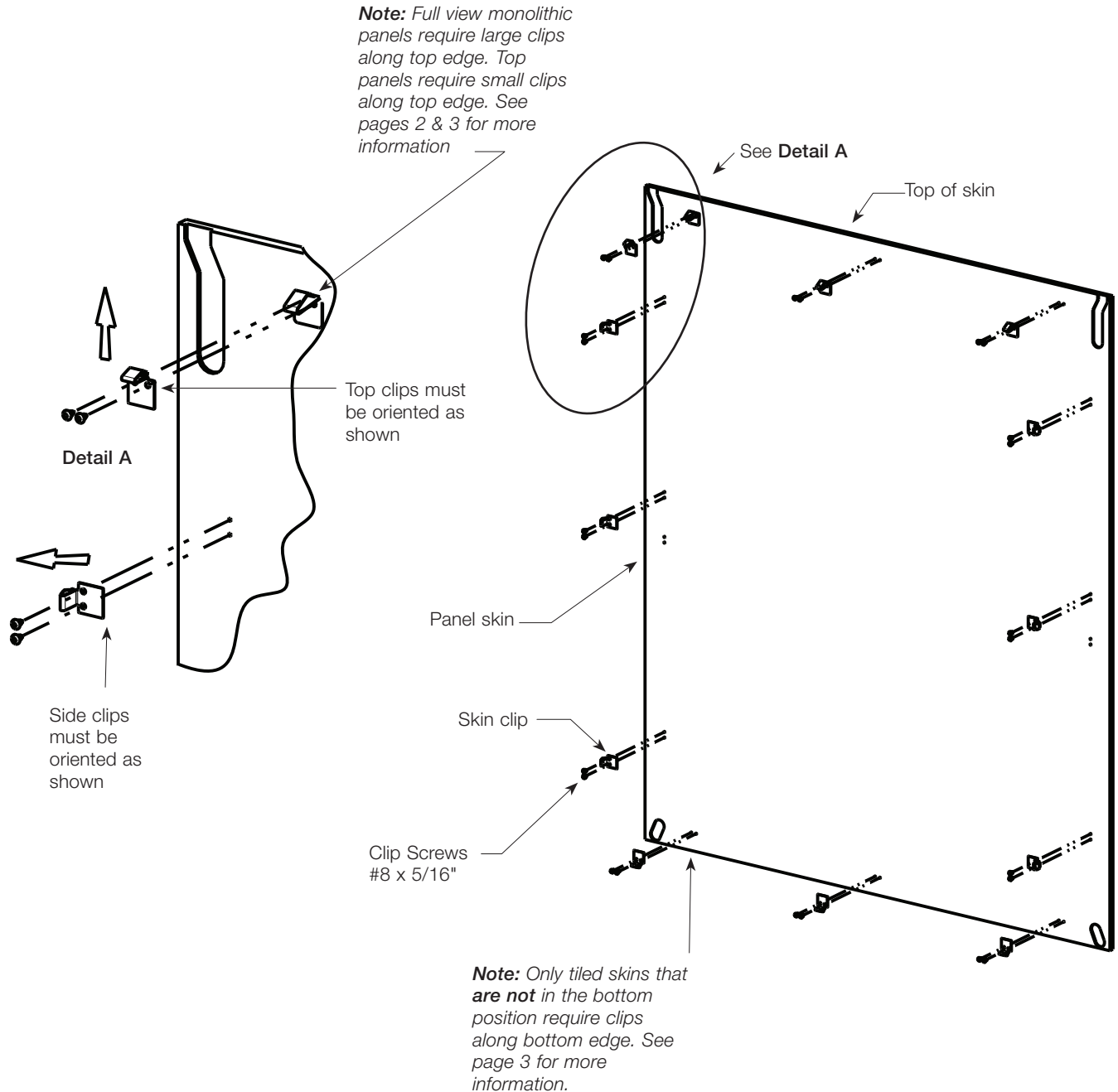

Dividends Horizon Laminate/Veneer Tiles, continued

When installing laminate or veneer tiles at the top of a full view panel frame with a stacking frame or stacking screen mounted above, clips are required on the top of the tile where it meets the top of the panel frame. See details below.

For full view (no top trough) panel frames, clips are included in the hardware pack.

Top Rail

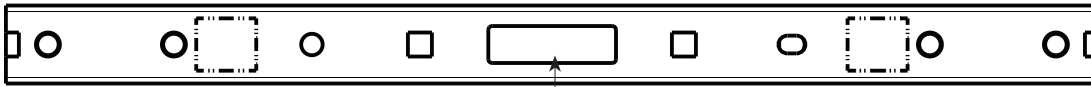

Bottom view of top rail

Clip engagement
in center cut-out

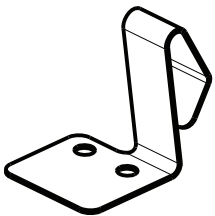

Large style clip

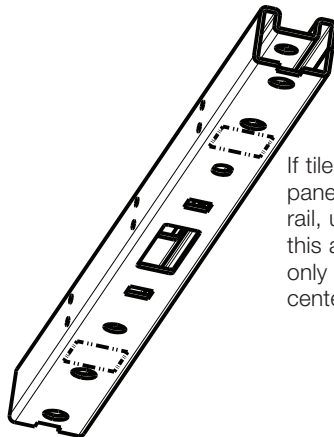

If tile extends to top
panel frame horizontal
rail, use this clip. In
this application use
only one (1) clip at the
center of the tile.

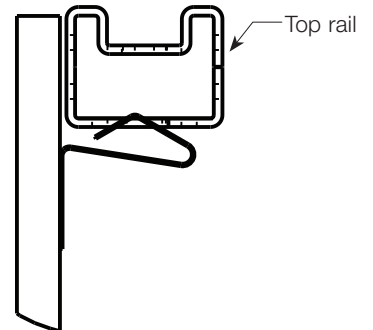

Top rail

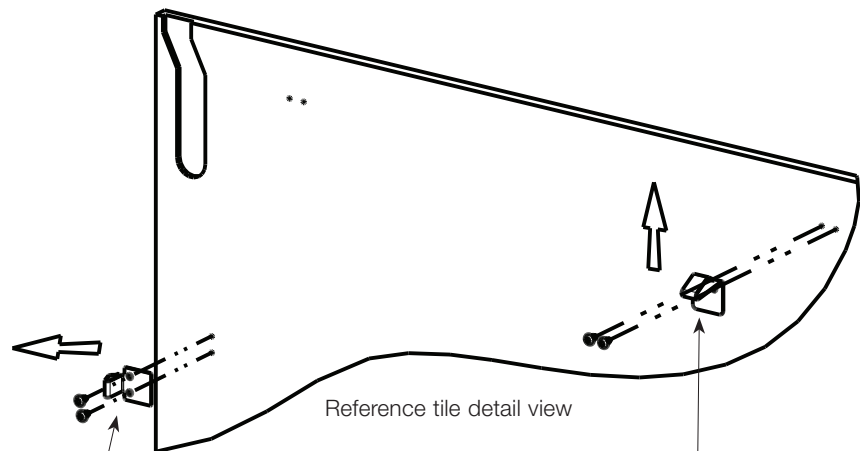

Reference tile detail view

Side clips must be
oriented as shown

Top clips must be
oriented as shown

Dividends Horizon Laminate/Veneer Tiles, continued

When installing laminate or veneer tiles in a tiled skin arrangement, clips are required on the top and bottom of the tile where it meets a tile rail. See details below

For full view (no top trough) panel frames, clips are included in the hardware pack.

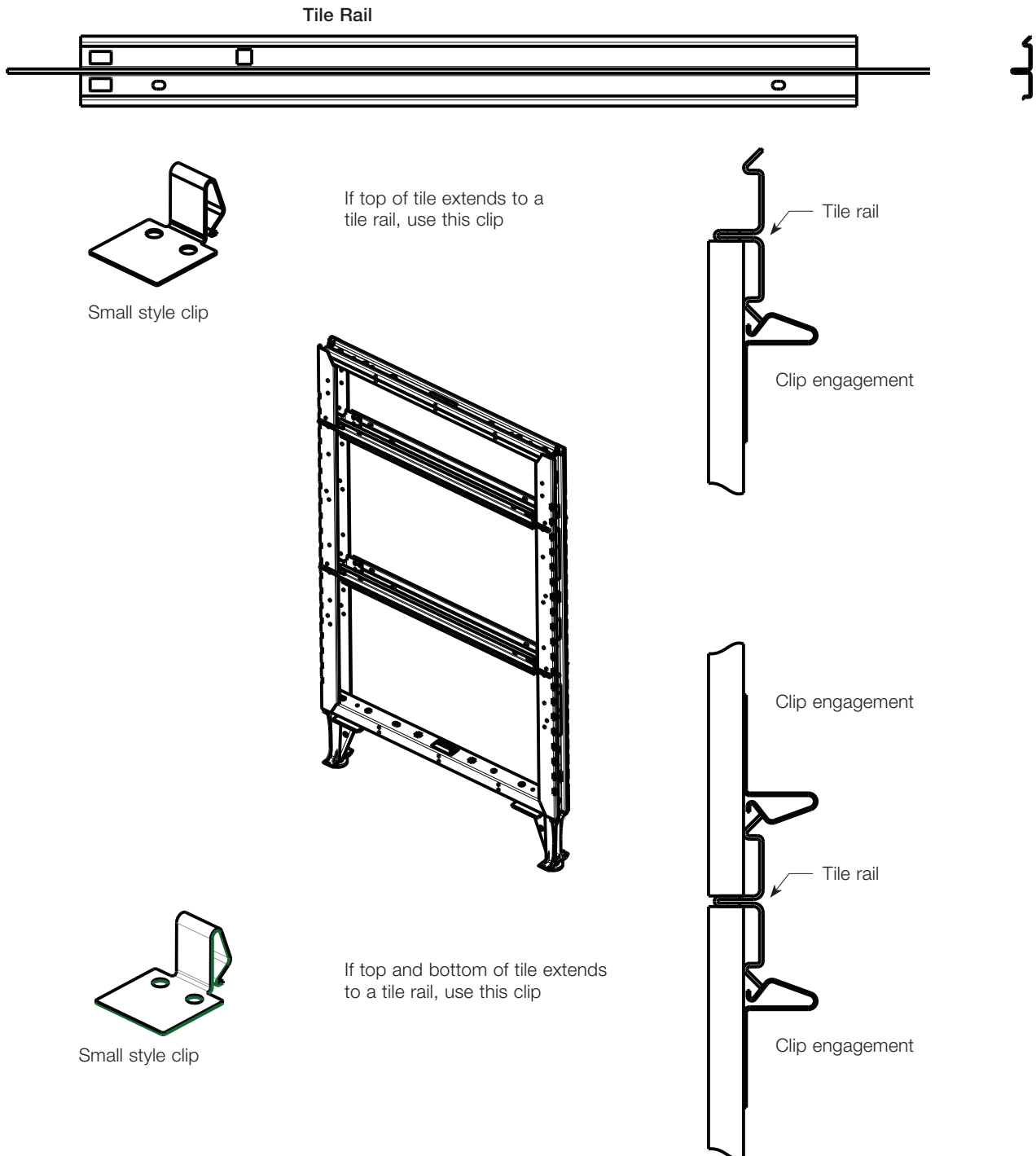

Dividends Horizon® Laminate/Veneer Tiles

"To Floor" Tiles

"To Floor" Tiles

1. Attach clips with two (2) screws each.
Orient clips to face outward as shown in Detail B.

Note: No clips are required along bottom edge.

2. See page 2 for instructions on top clips.

3. Remove floor channel from the panel frame, and attach to skin with three (3) screws as shown. All screws must be fully seated.

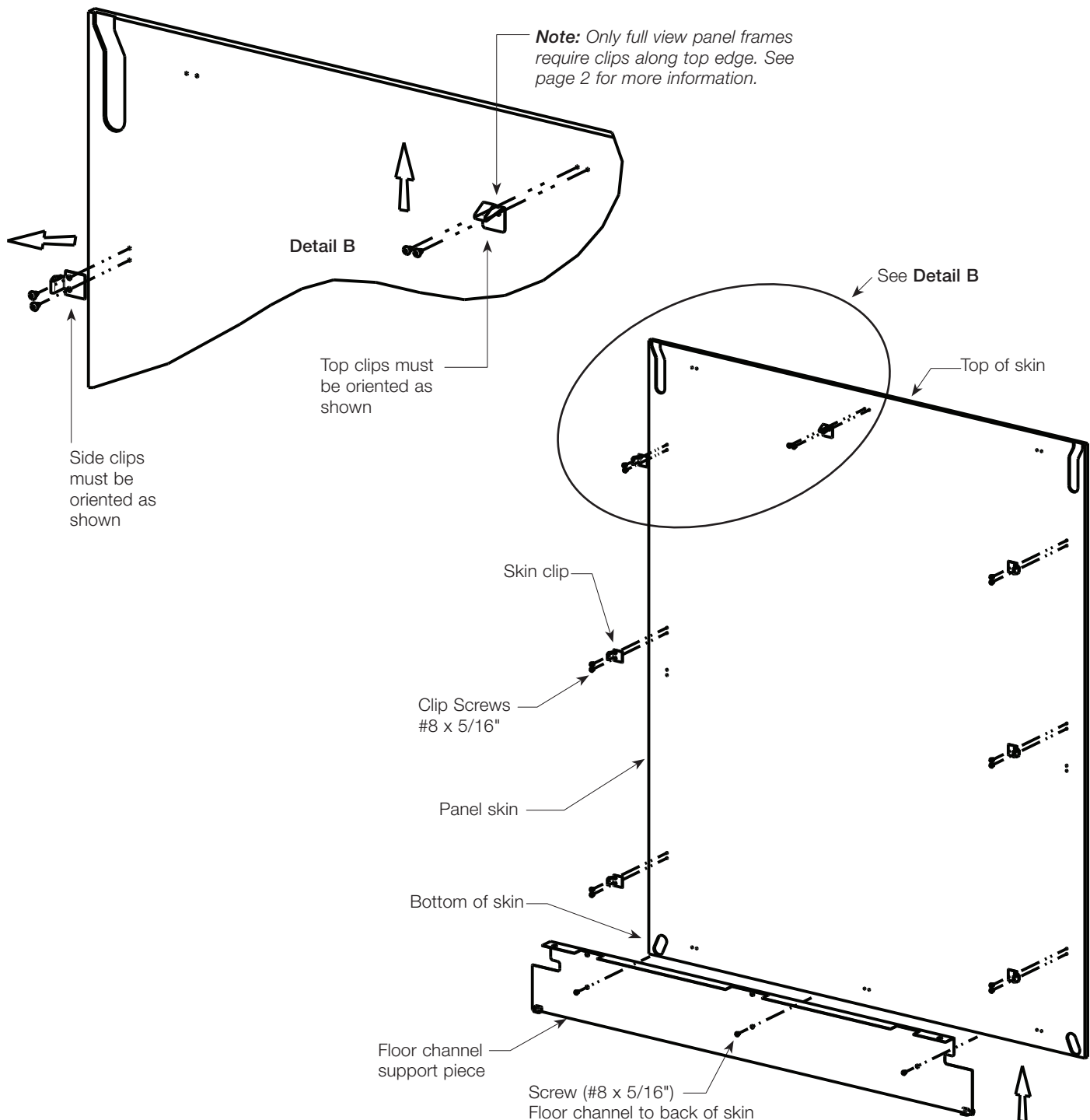

Dividends Horizon® Laminate/Veneer Tiles

Installing tiles on panel frame (“to floor” tiles shown on topway panel frame)

Monolithic to Raceway & Open Base, and Tiled Skins push straight through onto Full View Panel Frames.

The Topway Panel Frame, however, has a built-in “skin capture” detail in the top channel. Follow the steps shown below for installation on Topway Panel Frames.

Step 2.

Tip the top edge of the skin toward the panel frame and push upward into flange of panel frame top rail

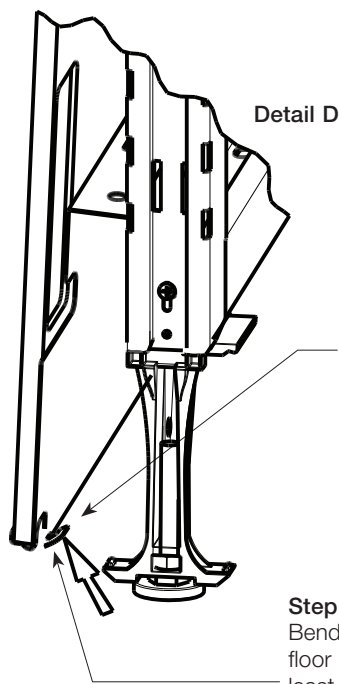
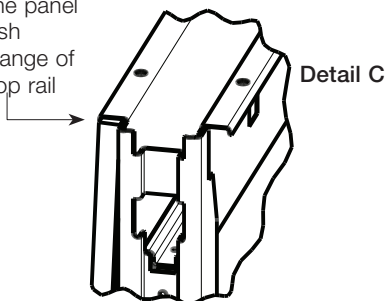

Note: No clips along the bottom edge.

1. Bend both hooks in the floor channel upward at least 45°.
2. Tip the top edge of the skin toward the panel frame and push upward into the flange of panel frame top rail.

3. While continuing to push upward, move the bottom edge of the skin in and lift the hooks in the floor channel over the webs in the feet.

- Step 1. Bend both hooks in the floor channel upward at least 45°.

3. While continuing to push upward, move the bottom edge of the skin in and lift the hooks in the floor channel over the webs in the feet
4. Secure floor channel to bottom frame rail with (2) Hex flange bolts. Use one at each end.

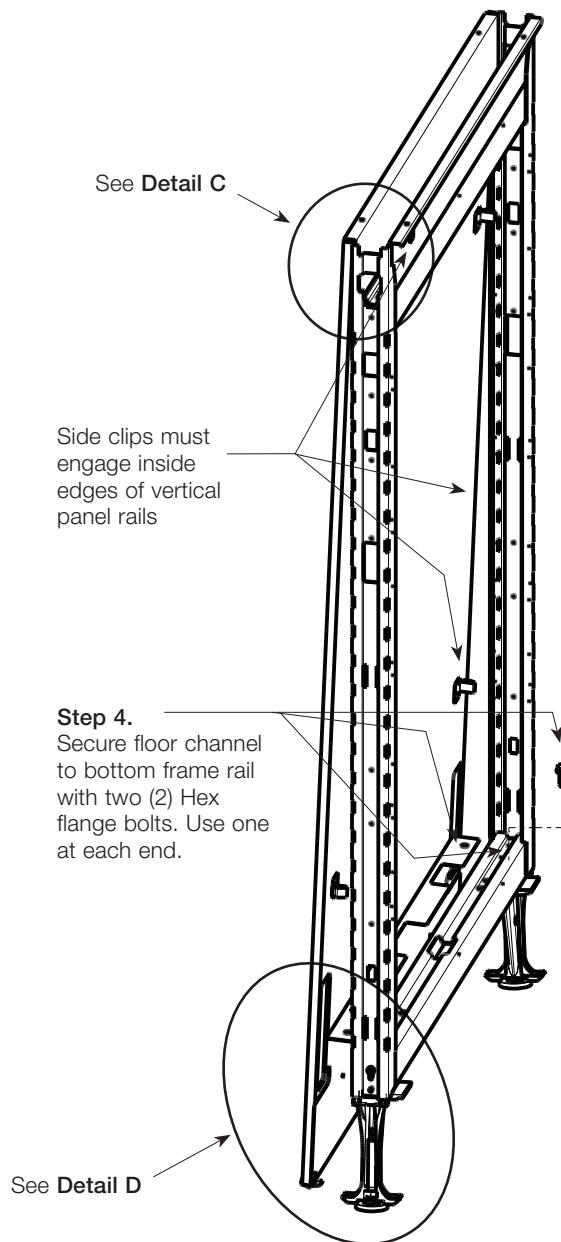

DISASSEMBLY FOR RECYCLING

Materials Identification and Segregation:

Where possible plastic components are marked with ASTM recycling codes. Use these codes to identify material type for recycling. Non-marked components should

be treated as mixed plastic. Ferrous metals can be identified using a small magnet for recycling. Non-ferrous metals should be separated and recycled separately.

To disassemble product, reverse the above installation steps.