

# LSM Table - Installation Instructions

Pattern number: L3-TV36, L3-TV54, L3-VV60, L3-VV62, L3-VV70, L3-VV72

L3-XV90, L3-XV92, L3-XV94

EXPLODED VIEW.

## Parts List:

- A. V-Base
- B. Glide (3 per base)
- C. Trough End
- D. Trough Center
- E. Side Rail End Pieces (2x left, 2x Right)
- F. Side Rail Center Pieces
- G. Leg Connector Bracket
- H. Triangular Leg
- I. Triangular Leg Plate
- J. Bottom Access Panels w/ Thumb Screw
- K. Plastic Covers for Trough Cutouts
- L. 1/4-20 x 1" Zinc Carriage Bolt (Leg Connector Bracket to Trough)
- M. 5/16" x 3/4" Zinc Flat Washer (Leg Connector Bracket to Trough)
- N. 1/4-20 Lock Nut (Leg Connector Bracket to Trough)
- O. 5/16-18 Serrated Flange Nut (Support Rail to V-Base)
- P. 5/16-18 x 1" Black Flat Head, Phillips Machine Screw (Support Rail to V-Base)
- Q. 1/4-20 x 3/4" Washer Head Screw (Trough to V-Base)
- R. #12 x 3/4" Phillips Pan Head Wood Screw (Trough to Subtop)
- S. 5/16-18 x 1" Phillips Pan Head Machine Screw (V-Base to Subtop)
- T. 5/16-18 x 3/4" Phillips Flat Head Machine Screw (Mending Plate to Subtop)
- U. 5/16-18 x 1 1/2" Black Pan Head Hex Drive Screw (Triangular Leg Plate to Support Rails)
- V. 1 1/8" Large Washer (Triangular Leg Plate to Support Rails)
- W. 5/16-18 x 1" Black Socket Cap Screw (Triangular Leg Plate to Top/Subtop)
- X. 3/8-16 x 2 1/2" Button Head Screws (Triangular Leg Plate to Triangular Leg)
- Y. 3/8-16 x 1 1/4" Button Head Screws (Triangular Leg Plate to Triangular Leg)
- Z. Black Mending Plates

## Tools needed:

Phillips screwdriver  
Adjustable wrench  
Allen wrenches

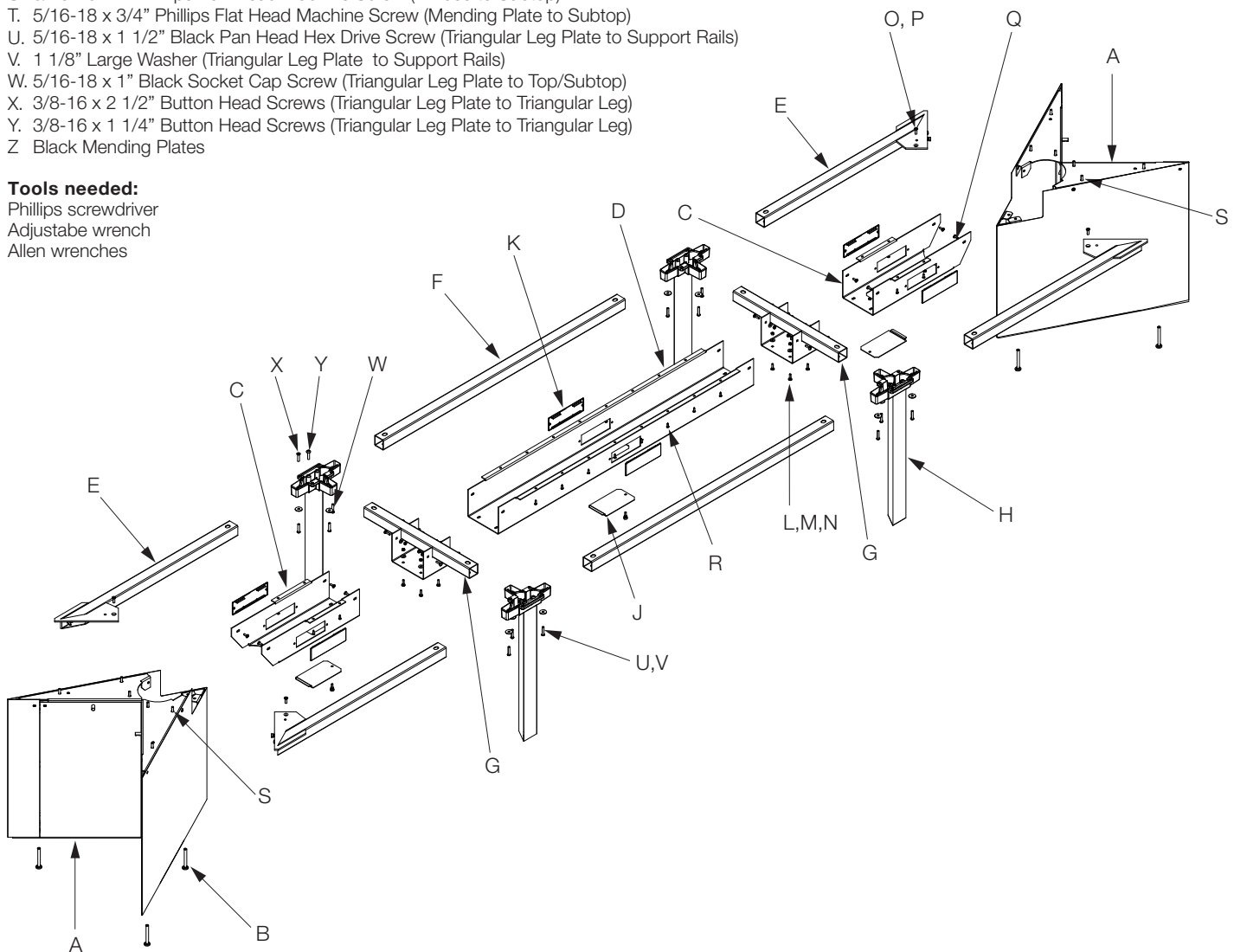

# LSM Table - Installation Instructions

Pattern number: L3-TV36, L3-TV54, L3-VV60, L3-VV62, L3-VV70, L3-VV72  
L3-XV90, L3-XV92, L3-XV94

## HARDWARE



1/4-20 x 1"  
Zinc Carriage Bolt  
**L**



5/16" x 3/4"  
Zinc Flat Washer  
**M**



1/4-20 Lock Nut  
**N**



5/16-18  
Serrated Flange Nut  
**O**



5/16-18 x 1"  
Black Flat Head  
Phillips machine screw  
**P**



1/4-20 x 3/4"  
Washer Head Screw  
**Q**



#12 x 3/4"  
Phillips Pan Head Wood Screw  
**R**



5/16-18 x 1"  
Phillips Pan Head Machine Screw  
**S**



5/16-18 x 3/4"  
Flat Head Machine Screw  
**T**



5/16-18 x 1 1/2"  
Black Pan Head Screw  
**U**



1 1/8" Large Washer  
**V**



5/16-18 x 1"  
Black Socket Cap Screw  
**W**



3/8-16 x 2 1/2"  
Button Head Screw  
**X**



3/8-16 x 1 1/4"  
Button Head Screw  
**Y**



Leveler for Triangular Leg

# LSM Table - Installation Instructions

Pattern number: L3-TV36, L3-TV54, L3-VV60, L3-VV62, L3-VV70, L3-VV72

L3-XV90, L3-XV92, L3-XV94

## STEPS.

1. Remove the V-bases from the boxes, they are full assembled. Adjust the glides(B) of the V-Base so they are just proud of the base skirts edge.

2. Attach the Triangular leg plate (I) to the Triangular leg (H) with (2) 3/8-16 x 2 1/2" Button Head Screws (X) and (2) 3/8-16 x 1 1/4" Button Head Screws (Y). See Fig 1.

3. Adjust the glides (b) of the v-bases so that they are just proud to the base skirts edge. See Fig 2

4. Locate the Leg Connector Bracket (G) and attach both of the assembled Triangular legs with the 5/16-18 Black Pan Head Hex Drive Screws (U) and the 1 1/8" Large Washers (V). See Fig 3

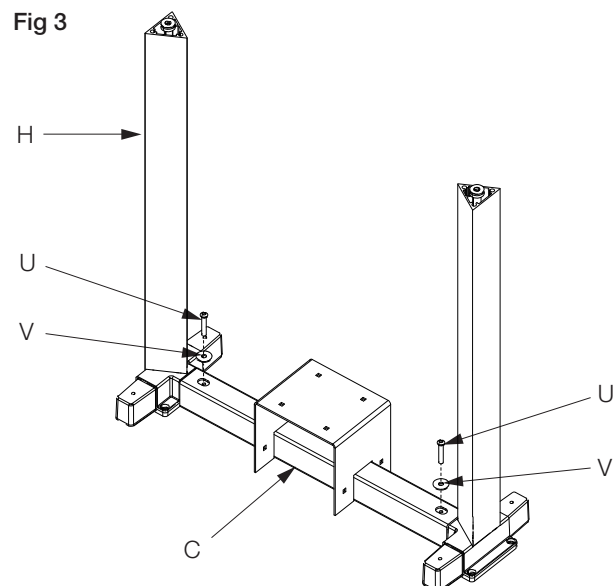
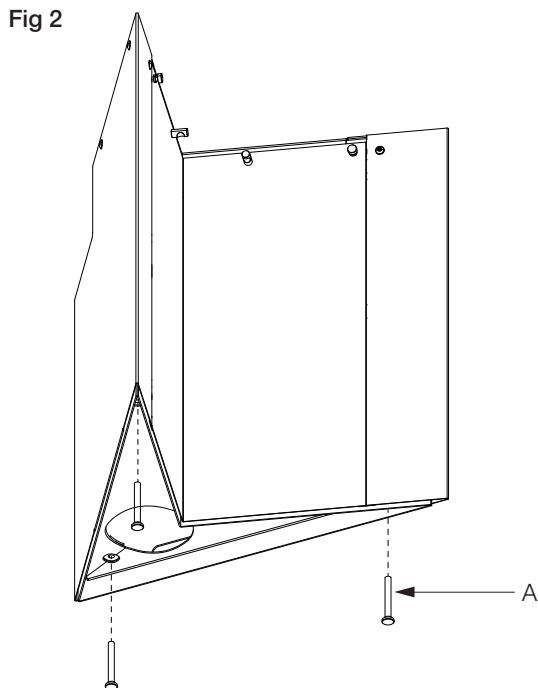
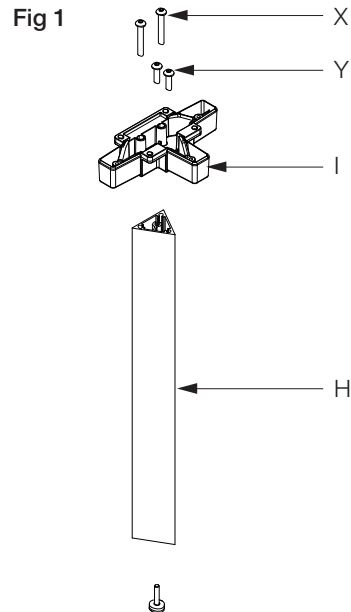

# LSM Table - Installation Instructions

Pattern number: L3-TV36, L3-TV54, L3-VV60, L3-VV62, L3-VV70, L3-VV72

L3-XV90, L3-XV92, L3-XV94

## STEPS

5. Take off the V-Base (A) removable panel by unscrewing the two thumb screws and then lift the cover with two round knobs. See Fig 4.

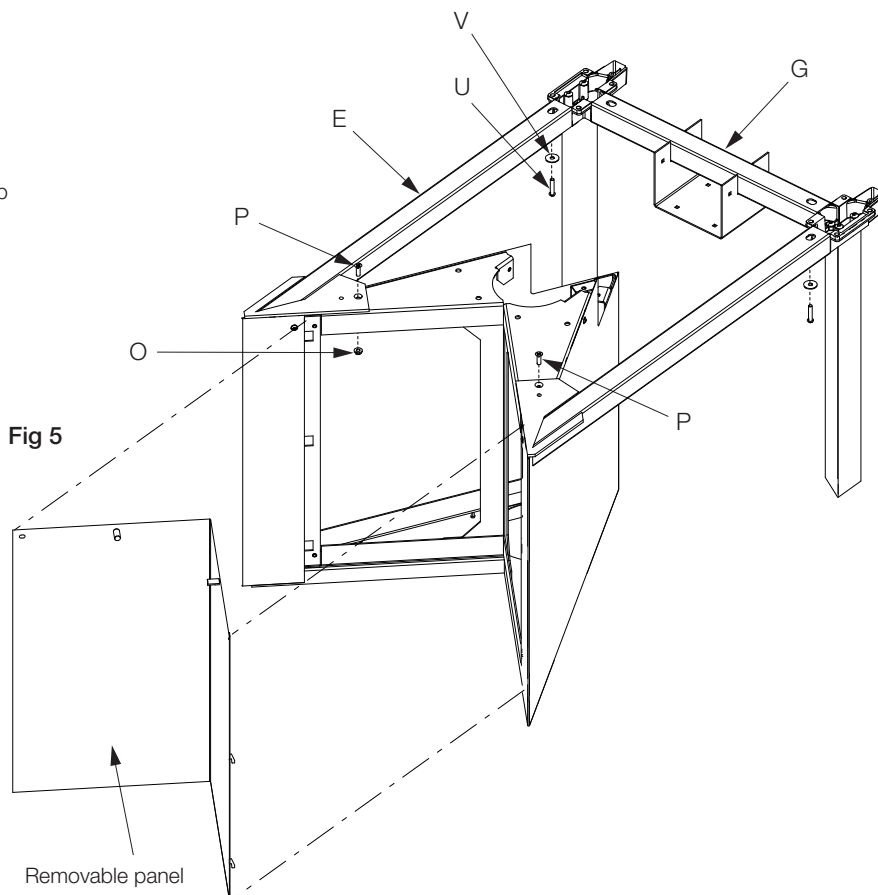
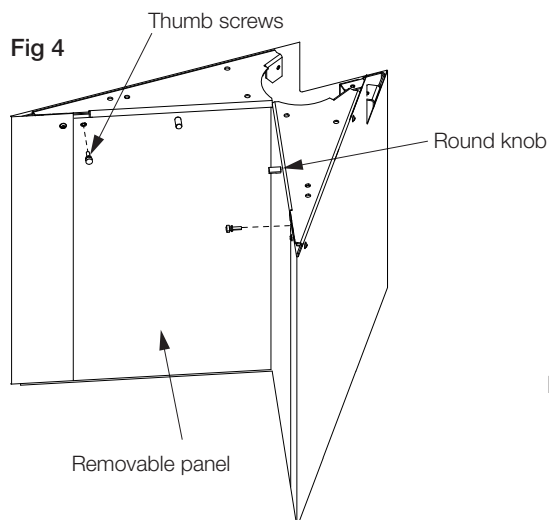

6. Rotate the Triangular Leg Assembly that was previously assembled in Step 4 so that it is standing in the upright position.

7. Slide the Left Side Rail End Piece (E) over the Triangular Leg Plate and secure it with a 5/16-18 x 1" Black Pan Head Screw (U) and 1 1/8" Large washer (V). Repeat this step for the Right Side Rail End Piece.

8. Once the Side Rail Ends are attached to the Triangular Leg Plates, move the whole assembly to the correct distance from the V-Base and attach the Side Rail Ends to the top of the V-Base with 5/16"-18 x 1" Black Flat Head, Phillips Machine screws (P) and 5/16-18 Serrated Flange Nuts (O). See Fig. 5.

9. Attach the Trough End (C) to the V-Base (A) with 1/4-20 x 3/4" Washer Head Screws (Q). Attach Triangular Leg Assembly to the Trough End (C) with 1/4-20 x 1" Zinc Carriage Bolts (L), 5/16 x 3/4" Zinc Flat Washers (M), and 1/4-20 Lock Nuts (N).

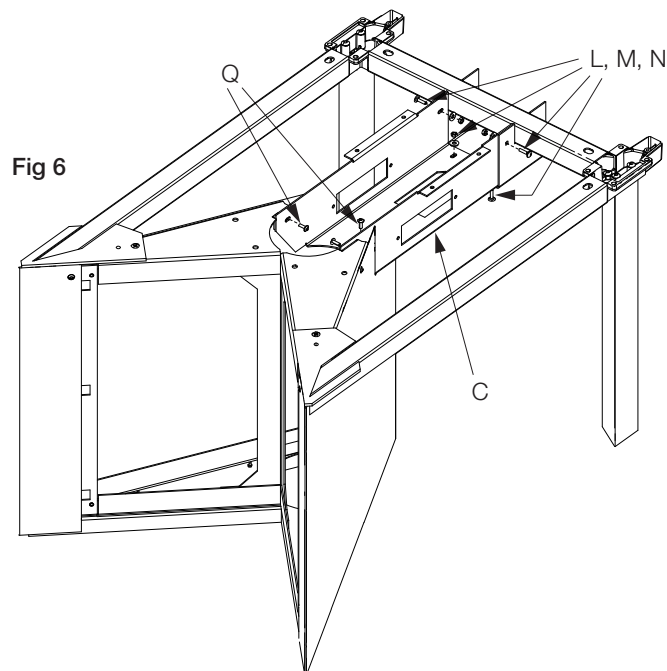

# LSM Table - Installation Instructions

Pattern number: L3-TV36, L3-TV54, L3-VV60, L3-VV62, L3-VV70, L3-VV72

L3-XV90, L3-XV92, L3-XV94

10. Position the (2) Side Rail Center Pieces (F) between the Triangular Leg Assemblies and secure them with 5/16-18 x 1" Black Pan Head Screws (U) and Large Washers (V). See Fig. 7

11. Attach the Trough Center (D) to the L-Leg Cross Member Assembly with 1/4-20 x 1" Zinc Carriage Bolt (L), 15/16 x 3/4" Flast Washer (M), and 1/4-20 Lock Nut (N). See Fig 8.

12. For 4, 5, and 6 segment tables, repeat steps 10 and 11 as needed.

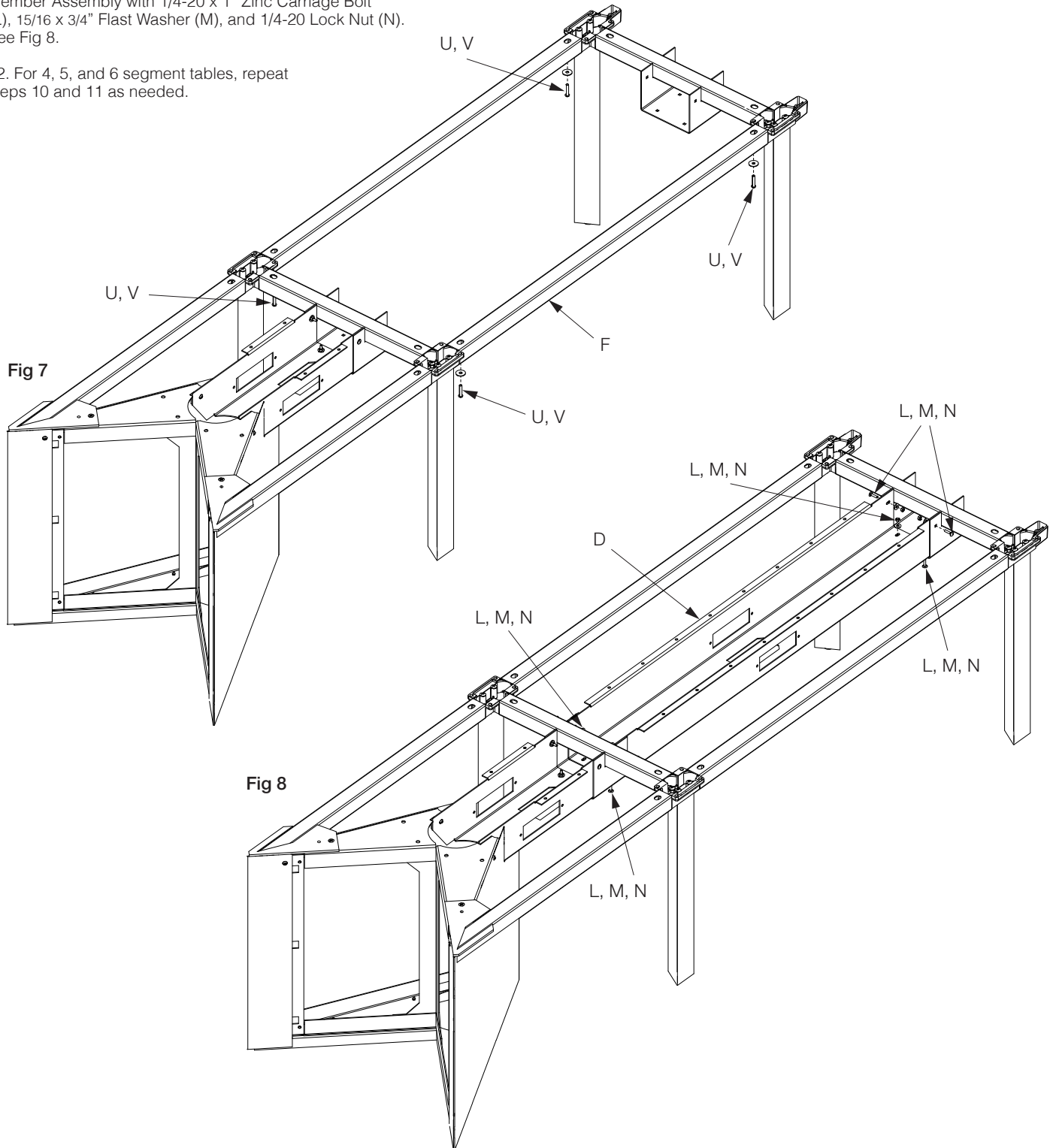

# LSM Table - Installation Instructions

Pattern number: L3-TV36, L3-TV54, L3-VV60, L3-VV62, L3-VV70, L3-VV72

L3-XV90, L3-XV92, L3-XV94

## STEPS.

13. Position second v-base at the correct distance from table assembly.

14. Attach Side Rail End Pieces (E) to L-Leg Cross Member Assembly with 5/16-18 x 1 1/2" Black Pan Head Hex Drive Screws (U) and Large Washers (V). Attach the plate that is welded to the Side Rail End of the V-Base with 5/16-16 x 1" Black Flat Head Machine Screws (P) and Serrated Flange Nut (O). See Fig 9.

15. Attach the second Trough End (C) to the V-Base and Triangular Leg Assembly with 1/4-20 x 3/4" Washer Head Screws (Q).

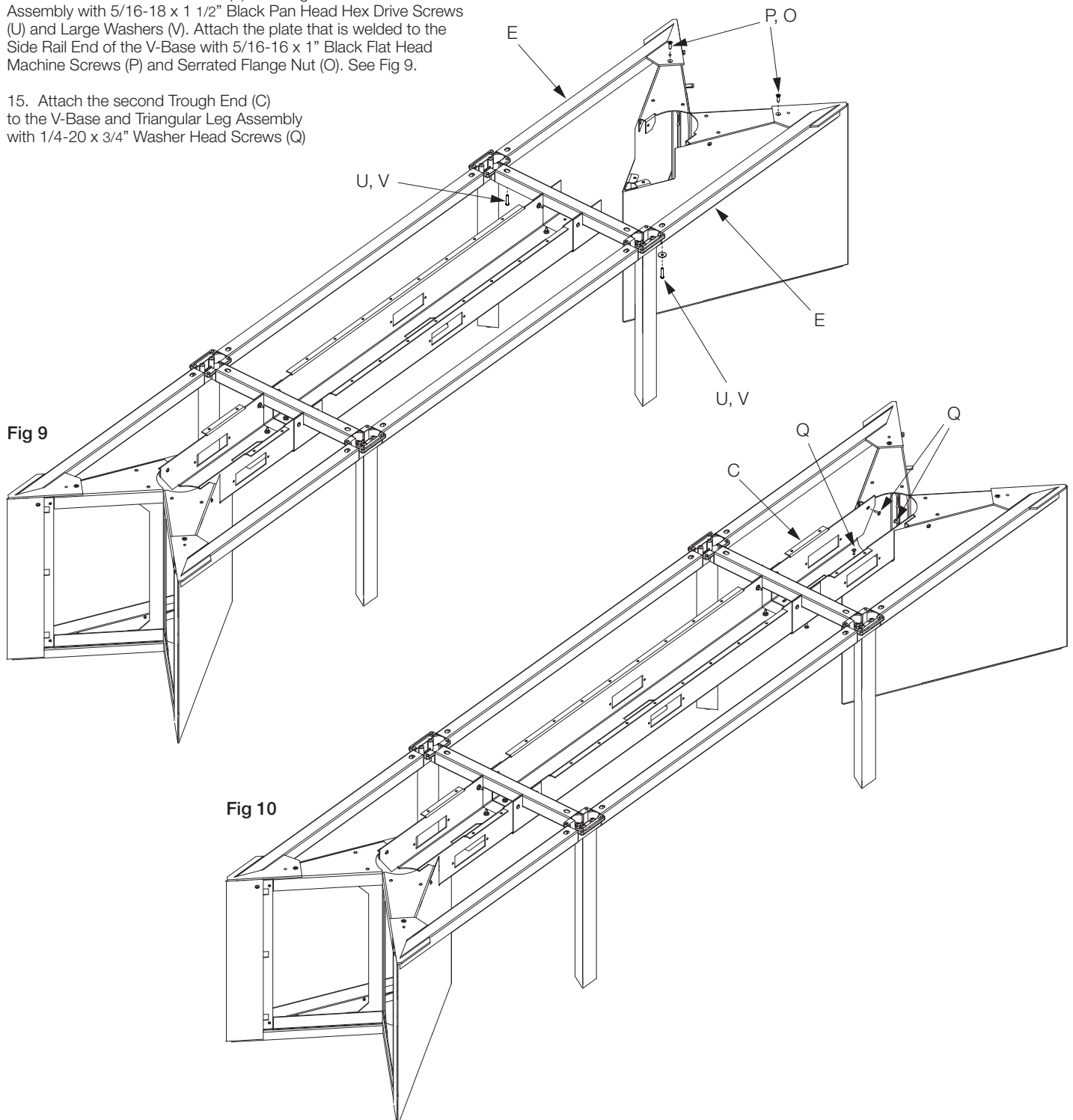

# LSM Table - Installation Instructions

Pattern number: L3-TV36, L3-TV54, L3-VV60, L3-VV62, L3-VV70, L3-VV72

L3-XV90, L3-XV92, L3-XV94

## STEPS.

16. Insert the Powerport into the trough if applicable. Fasten with thumb screws.

Run the Powerport cables through V-Base to the floor monument (power outlet).

Insert Blank Plastic Cover Plates (K) into the trough cutouts where Powerports are not used.

17. If there is any table top electrical box, use the bottom trough latch (J) and the V-Base Removable Cover Opening for wiring access and installation. Insert and fasten the latch with thumb screws.

18. Adjust the glides (B) that are incorporated into the V-Bases to level the entire assembly so that the top surface is flat and horizontal.

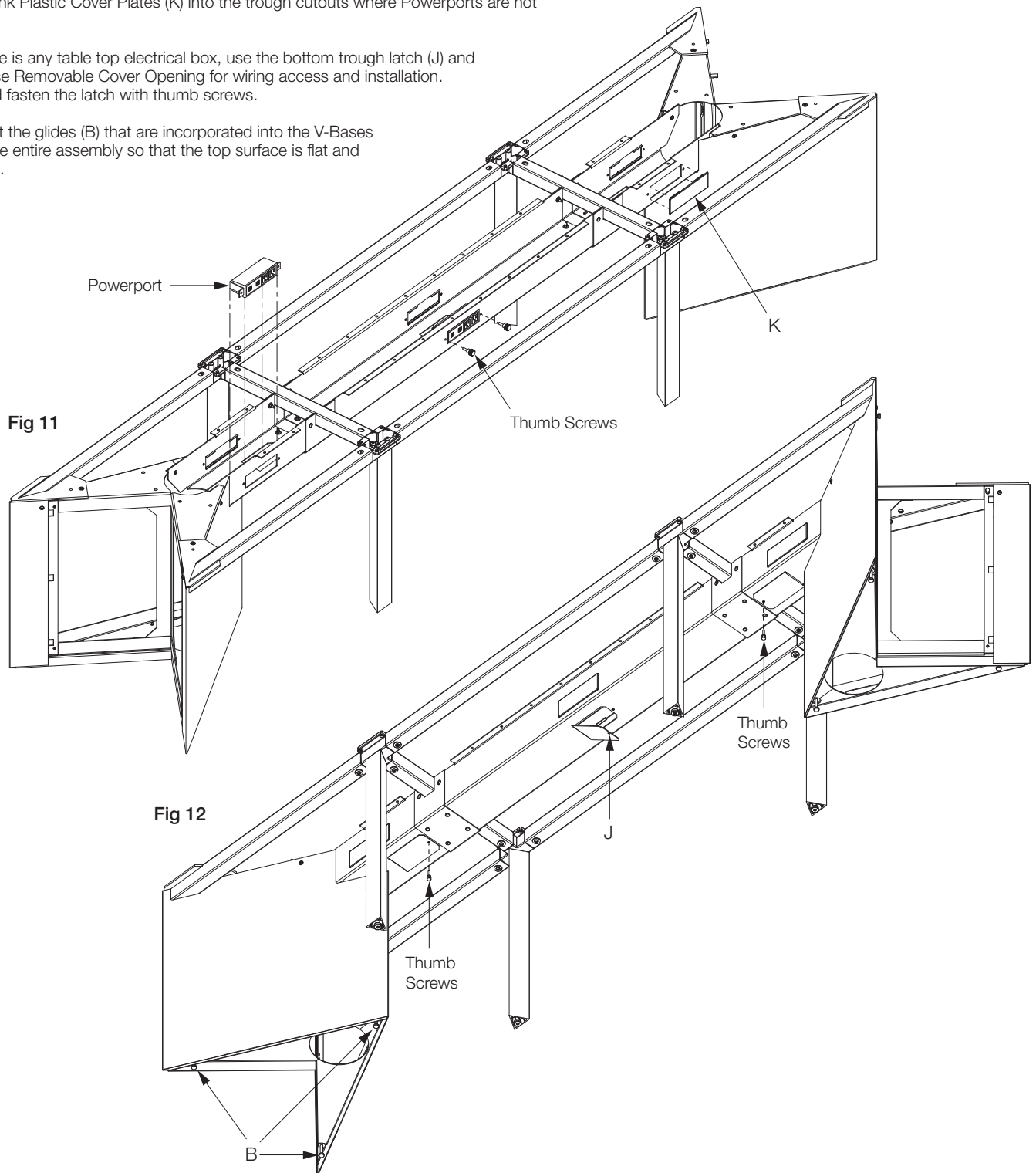

# LSM Table - Installation Instructions

Pattern number: L3-TV36, L3-TV54, L3-VV60, L3-VV62, L3-VV70, L3-VV72  
L3-XV90, L3-XV92, L3-XV94

## STEPS.

19. Attach either the Subtop or Table Top to the V-Base with 5/16-18 x 1" Phillips Pan Head Screws (S). Access these screws through the removable cover opening. The Subtops / Top have threaded inserts.

Note: Veneer and Laminate tops do not have subtops. All other materials require a subtop.

20. Attach the Trough to the subtop / top with #12 x 3/4" Pan Head Wood Screws (R).

21. Attach the Triangular Leg Plates to the subtop / top with 5/16-18 x 1" Black Socket cap Screws (W).

22. Attach the Mending Plates to the subtop / top.

23. Attach the Removable Base panels and tighten the (2) thumb screws.

24. If a separate top is placed on the subtop, shim as required to make all the sections level.

Fig 13

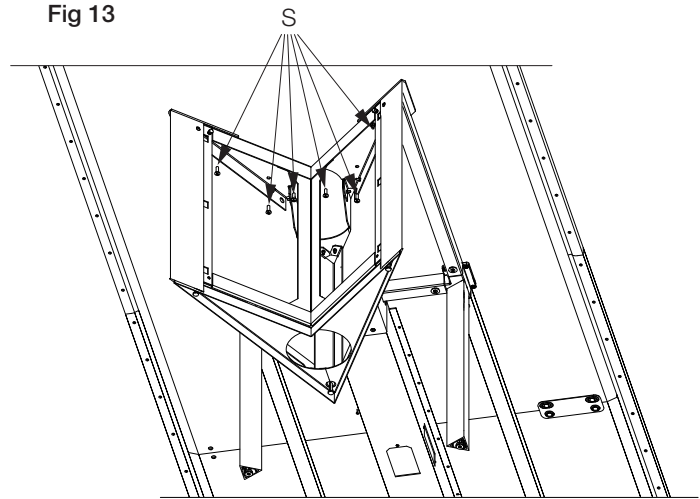

Fig 14

