

Sapper XYZ® Interpole Extended Channel Mount: Attach Mount to Interpole and then Arm to Mount

Tools Needed

- Phillips Screwdriver

1. If applicable, remove and retain any channel cover from Interpole.
Establish desired height on Interpole then drill (3) pilot holes for screws (A).

Note: Bottom of monitor support arm post will be 2 3/4" above the center mounting screw.

2. Install bracket (B) using (3) screws (A).
3. Attach mounting bracket (C) using (4) screws (D).
4. Install Sapper XYZ monitor arm by sliding the hole in the bottom of the post onto stem of mounting bracket (C). Seat firmly.
5. If applicable, cut Interpole channel cover carefully to correct lengths for below and above mount and reinstall.

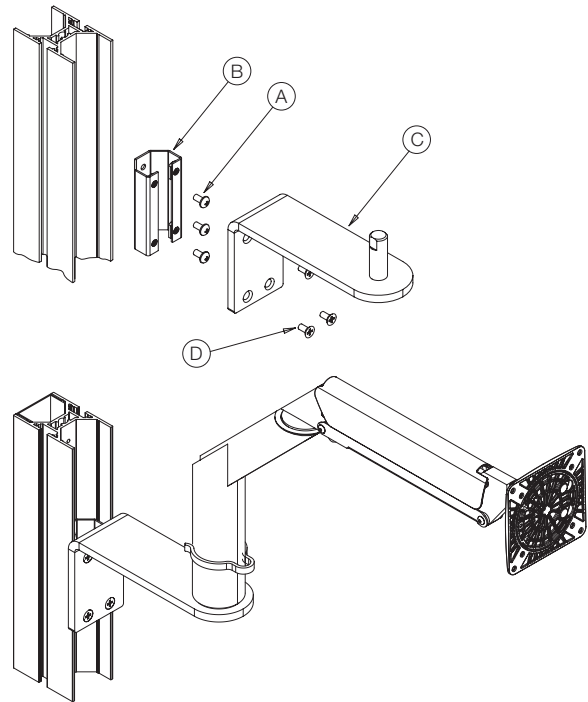

For complete monitor arm installation instructions, visit exchange.knoll.com/products/knollextra_inst.jsp

Sapper XYZ® Interpole Extended Channel Mount: Attach Mount to Interpole and then Arm to Mount

Tools Needed

- Phillips Screwdriver

1. If applicable, remove and retain any channel cover from Interpole.
Establish desired height on Interpole then drill (3) pilot holes for screws (A).

Note: Bottom of monitor support arm post will be 2 3/4" above the center mounting screw.

2. Install bracket (B) using (3) screws (A).
3. Attach mounting bracket (C) using (4) screws (D).
4. Install Sapper XYZ monitor arm by sliding the hole in the bottom of the post onto stem of mounting bracket (C). Seat firmly.
5. If applicable, cut Interpole channel cover carefully to correct lengths for below and above mount and reinstall.

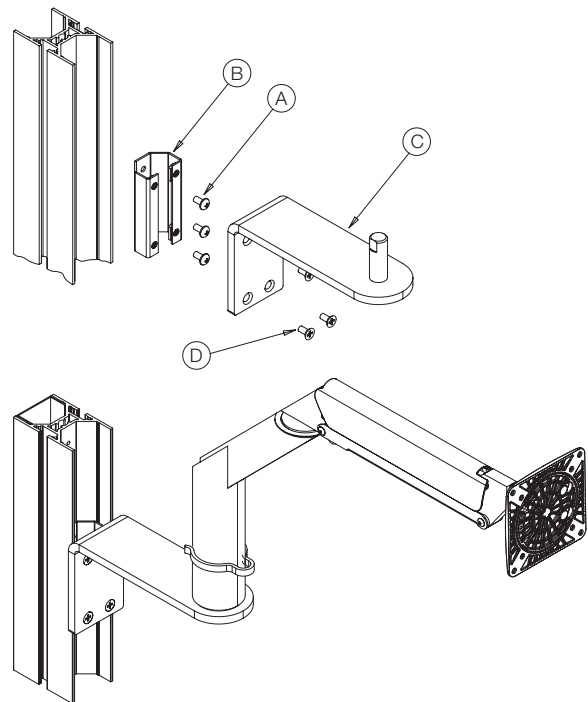

For complete monitor arm installation instructions, visit exchange.knoll.com/products/knollextra_inst.jsp