

10/10/2013

Sparrow™ LED Desktop Light Freestanding Base Installation Instructions

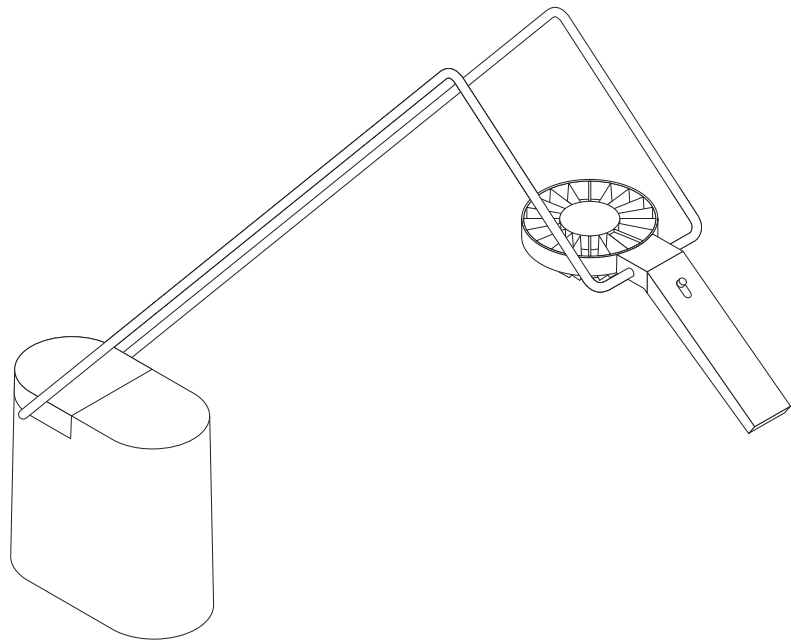

Step 1

Insert lamp frame into freestanding base.
Press down for secure connection.

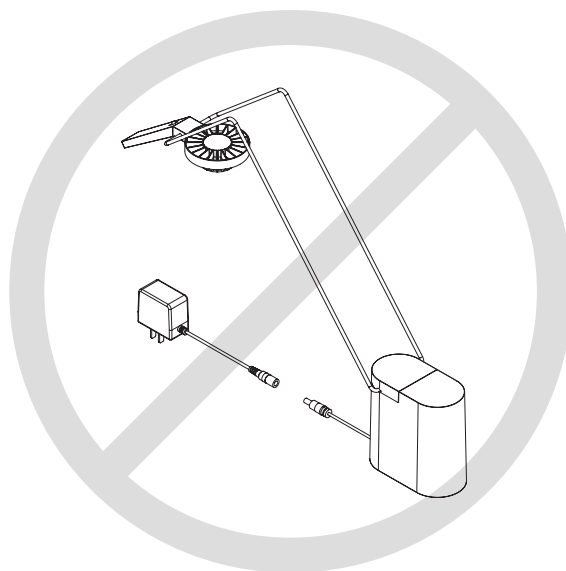
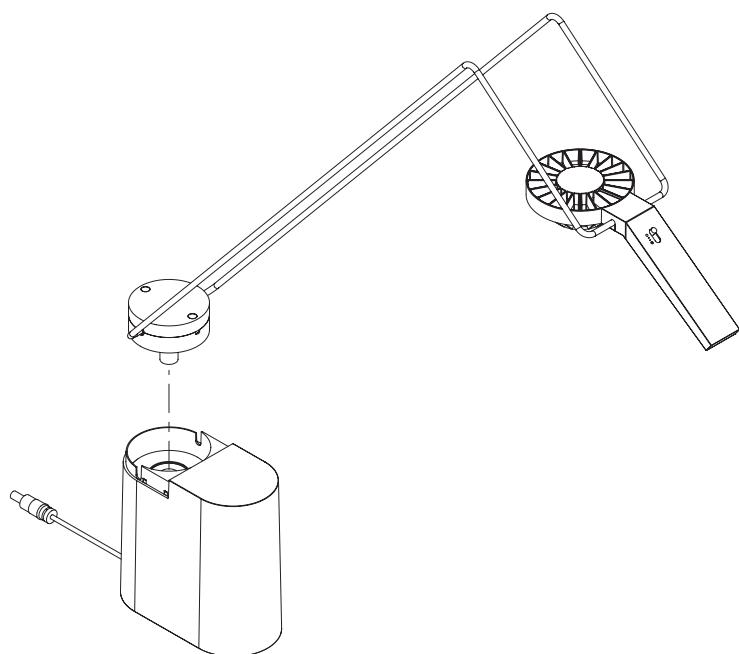

CAUTION:

Tipping hazard! Install lamp so lamp head rotates over base and NOT away from it.

Step 2

Snap cap into place.

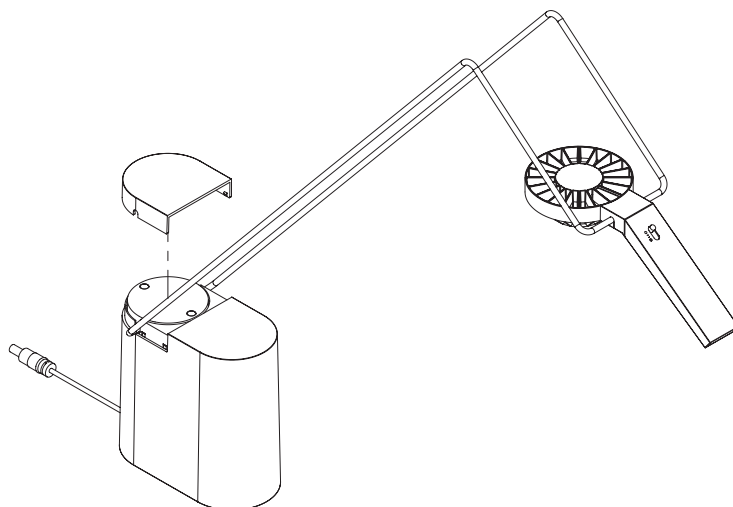

Step 3

Connect in-line power cord jack to power adaptor. Plug into power outlet.

Note: Sparrow offers a stepped dimmer for lighting control (100%, 60% and 30%).

