

Anchor Mobile Credenza

General notes

- Single units 48" wide and smaller require (4) 2-1/2" corner casters.
- Single units 60" wide and larger require (4) 2-1/2" corner casters and (1) 2-1/2" middle caster.
- In addition, units with drawers require (1) caster bracket and (1) 2" caster attached to each bottom drawer.

Installation Instructions

1. If unit has drawer(s), remove drawer(s). If unit has no drawers, proceed to step 4.
2. Place drawer on its back. Install caster bracket onto underside of drawer body using (4) 1/4-20 x 3/8" pan head screws. **(Fig. 1)**
3. Install 2" diameter caster onto caster bracket using (4) #10-24 x 3/8" pan head self-threading screws. **(Fig. 1)**
4. Place credenza on its back on a clean, nonabrasive surface (recommended a clean sheet of cardboard or a blanket wrap). **(Fig. 2)**
5. Install 2-1/2" diameter casters by aligning to (4) threaded holes in pre-mounted caster plates and attach using (4) #10-24 x 5/16" pan head machine screws per caster. (2) locking casters at front corners of unit, (2) non-locking at rear corners. If required, install (1) non-locking caster in middle of unit for units 60" wide and larger **(See general notes)**. **(Fig. 2)**
6. Rotate unit back to upright position.
7. Reinstall drawer(s) if unit has a drawer(s).

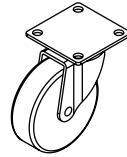
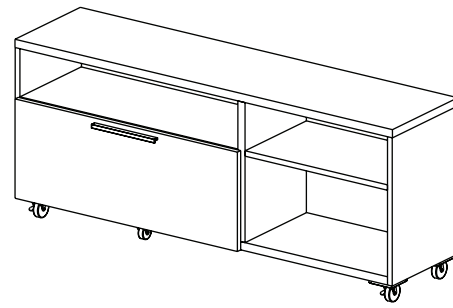

Non-locking
2 1/2" caster

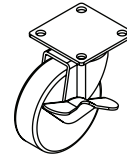

Locking
2 1/2" caster

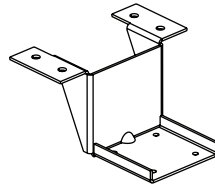
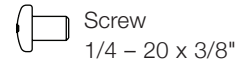

Caster Bracket
(for drawer)



Non-locking 2" caster
(for drawer)

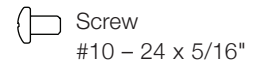

Fig. 1

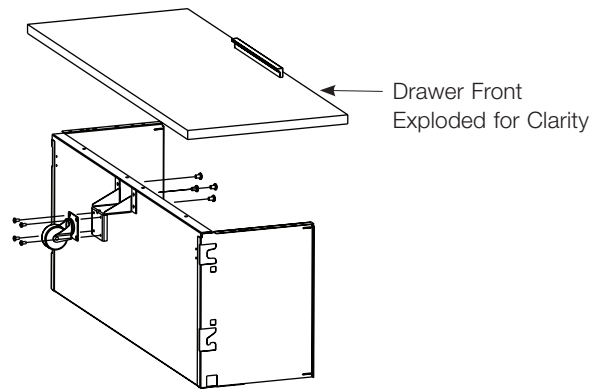

Fig. 2

Locking Casters at Front Corners

