

Slide Out Tower: Leveling

Hardware Shown For Reference

Drill bit - countersink for #8 screw

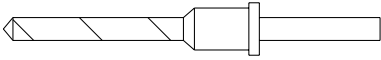

#8 x 1¼" wood screw, bright zinc



#8 x 1½" wood screw, black H01



1. Completely level unit using 4 glides on bottom. **(Fig. 1)**
2. Once tower is level, slide out drawer. Remove grommet plug from bottom of drawer.
3. Turn the caster stem with a screwdriver until drawer slides out smooth with no resistance and caster is contacting the floor. **(Fig.2)**
4. Reinstall grommet plug.
5. If there are 2 units being ganged side-by-side, proceed to instructions for ganging towers.

Fig. 1

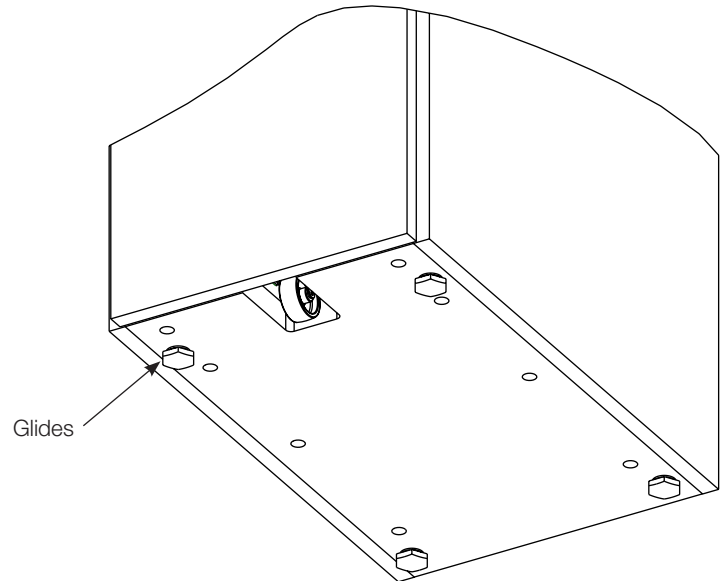
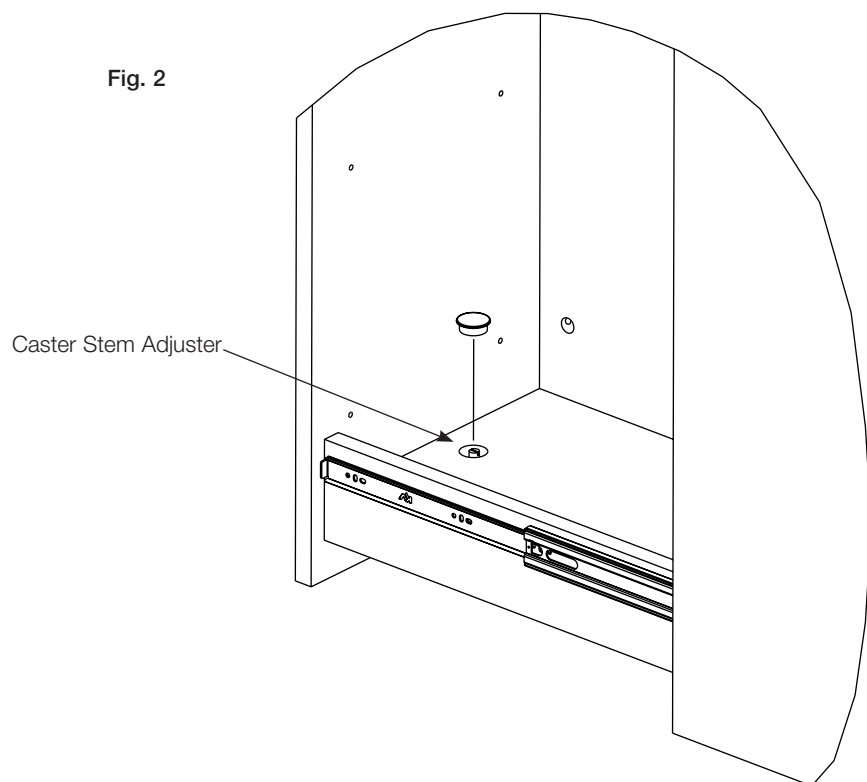

Fig. 2



Slide Out Tower: Ganging Side-by-Side Units with Common Top

1. Remove the slide out drawer from one tower by sliding drawer open and releasing slide lever on both slides to allow the inner slide member to release from middle slide member. (**Fig. 3**) (Note: Place block of wood or similar spacer underneath back of slide out drawer to help support rear of drawer while releasing slides. **Fig. 4**)

Fig. 3

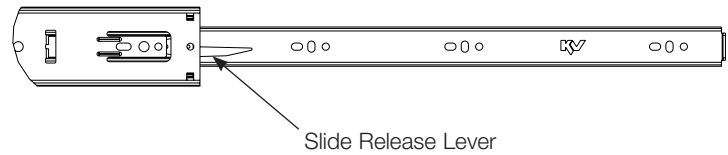

2. Place tower cases side-by-side; use pipe clamps top & bottom to clamp units together ensuring case fronts, tops & backs are aligned
3. Join cases using angled holes in the top of the end panels. (**Fig. 5**) If towers have been specified with factory-installed tops, skip steps 3, 8, 9 and 10:
 - a. Use a countersink-pilot drill for a #8 screw and drill angled holes (1¼" from front & rear) from one end panel into the adjoining end panel.
 - b. Using #8 x 1½" (black) wood screws connect the units at the top, ensuring the screw head is below the flat surface.
4. Continue to join cases using straight holes through the interior of the case:
 - a. Measure approx. 8" down from the top and 3" in from the FRONT and drill counter-pilot hole for #8 screw. Repeat this measuring approx. 8" up from the bottom and approx. center of case, using #8 x 1¼" (bright zinc) wood screws, connect the units at the front through the top, center and bottom pilot holes.
 - b. Repeat this at the REAR; Drill 3 countersink-pilot holes (top, bottom & center) for #8 screw towards rear of unit. Using #8 x 1¼" (bright zinc) wood screws, connect the units through the rear in top, center and bottom pilot holes.

Fig. 4

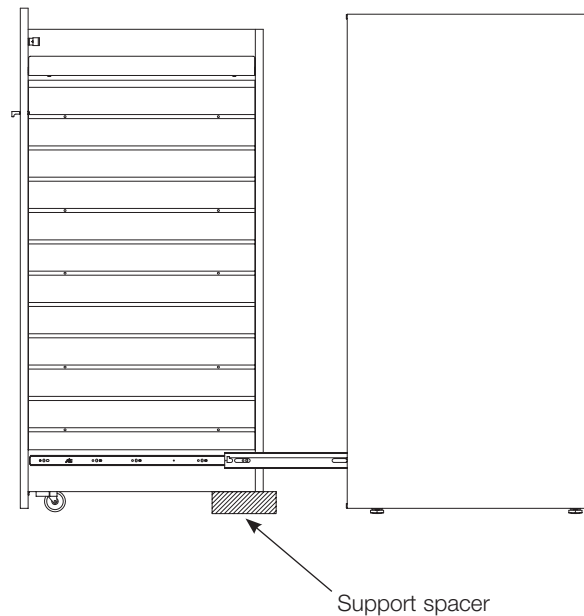
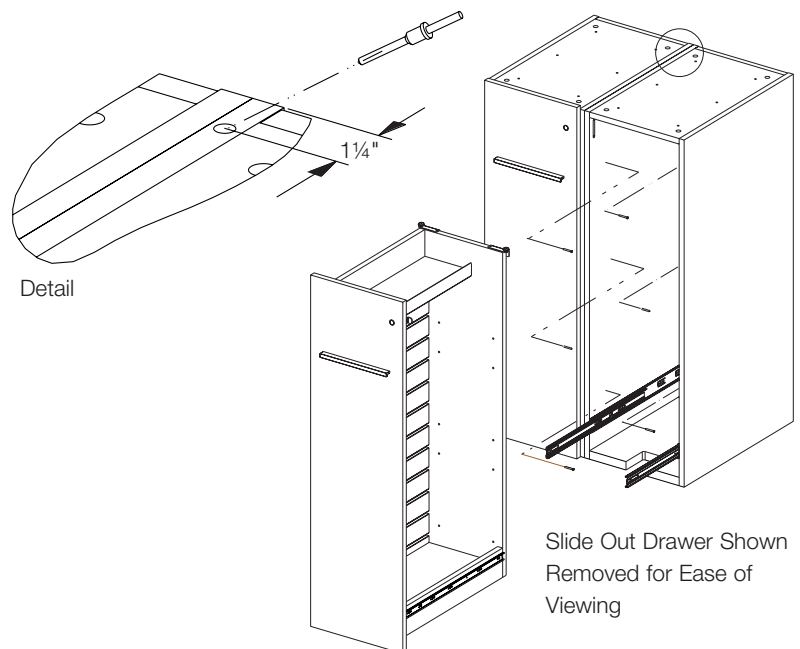

Fig. 5



Slide Out Tower: Ganging Side-by-Side Units with Common Top (cont.)

5. Remove pipe clamps. Using 2 people, line up slide members on slide out drawer and on case. (Note: Place block of wood or similar spacer underneath rear of drawer to aid in lining up slides). Insert inner slide member on drawer with middle slide member of case. Slide drawer approx. 25% closed, then pull all the way back open. Continue sliding drawer closed at 25% intervals (25%, 50%, 75% & 100% closed) and then pulling all the way back open until drawer is fully closed (approx. 3 to 4 closing & opening cycles). Failure to do so may cause damage to slides.
6. Inspect the front, top and back of the unit. If any gapping is noticed, drill additional countersink-pilot holes and use #8 x 1 $\frac{1}{4}$ " (bright zinc) wood screws. Clamping may be required.
7. Level both units following leveling instructions.
8. Once towers are ganged together and leveled, apply the supplied double sided tape around the perimeter approx. $\frac{1}{4}$ " from the outside edges. Also apply a single strip along the adjoining case edges. (**Fig. 6**)
9. Remove all the tape backers.
10. Carefully position the top over the towers, lower into place and apply pressure to the entire top.

Fig. 6

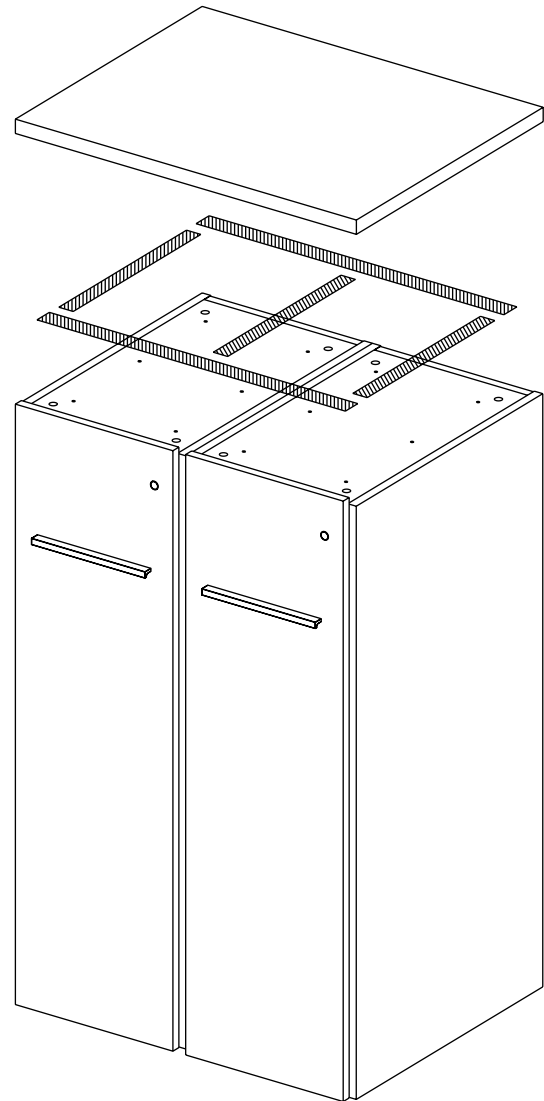

Anchor Slatwall Accessories

11. Test fit Slatwall Basket and/or Hook accessories. Brackets should loosely snap into Slatwall while allowing accessory to slide from side to side as needed. If too tight or too loose adjust bracket as necessary per below instructions.
12. To Adjust Hook: Insert slotted screwdriver into slot on bottom of bracket and slightly bend bracket up to tighten (**Fig. 7**) or down to loosen (**Fig. 8**).
13. To Tighten Basket: Insert slotted screwdriver into bottom of bracket slot and slightly bend bracket upward (**Fig. 9**).
14. To Loosen Bracket: Insert slotted screwdriver into top of bracket slot and slightly bend bracket downward (**Fig. 10**).

Fig. 7

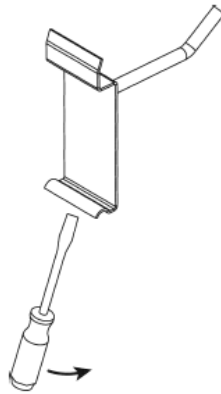

Fig. 8

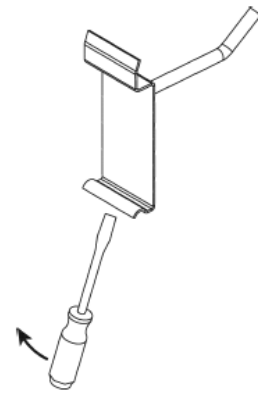

Fig. 9

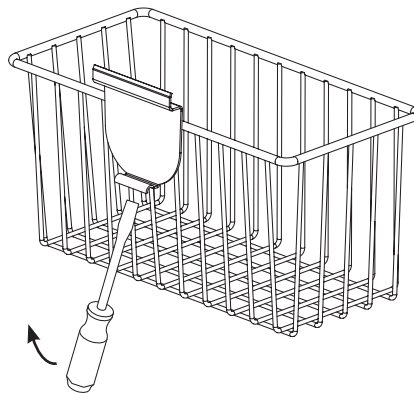

Fig. 10

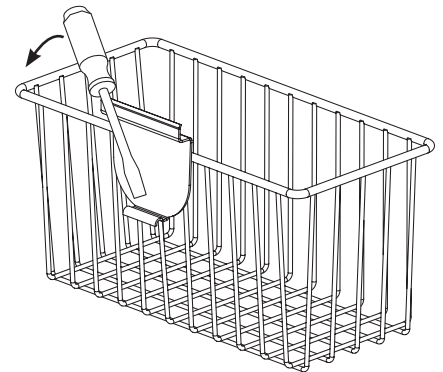

Fig. 4