

Installing Feet on a Single Unit

General notes:

- Single units 48" wide and narrower require 4 corner feet.
- Single units 60" wide and wider require 4 corner feet and 2 middle feet.
- When units are ganged together, 2 middle feet are required at the interface.

1. Place a non-marring support on the floor behind unit and lay unit on its back on the support. (Fig 1)
2. Remove all leveling glides where present. Discard or save for later. (Fig 1)
3. Align corner foot to (3) pilot holes as shown. Drive (3) screws into holes. (Note: Drive screws only partially to allow for adjustment.) (Fig 2)
4. Align foot as shown in (Fig 3). Finish driving in the screw closest to the corner of unit.
5. Ensure foot stayed aligned to case and finish driving (2) remaining screws. (Note: 4th hole does not require a screw. Only use if one of the other holes gets stripped out.)

If single unit requires middle feet proceed to step 6, if not, proceed to step 10.

6. Align middle foot to (4) pilot holes at front of unit as shown. Drive (4) screws into holes. (Note: Drive screws only partially to allow for adjustment.) (Fig 4)
7. Align foot as shown. Finish driving the (2) screws closest to the front edge as shown. (Fig 5)
8. Ensure foot stayed aligned to case and finish driving (2) remaining screws.
9. Repeat steps for middle foot at rear of unit.
10. Rotate unit back to upright position.
11. Level unit using adjustable glides on feet.

Fig. 1

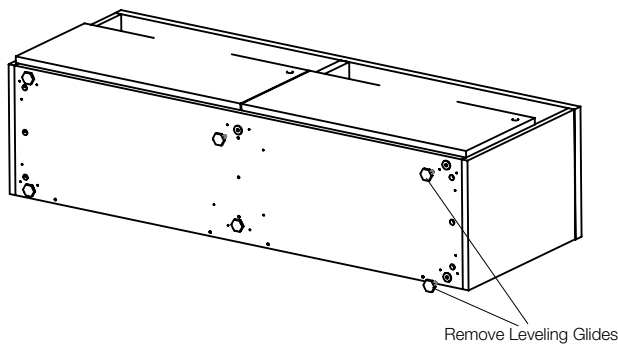

Fig. 2

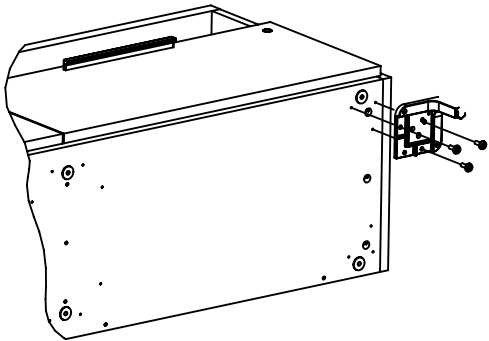

Fig. 3

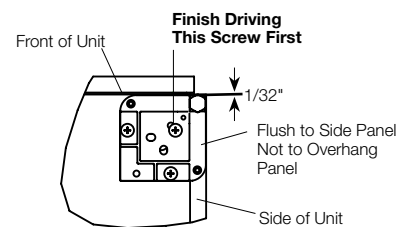

Fig. 4

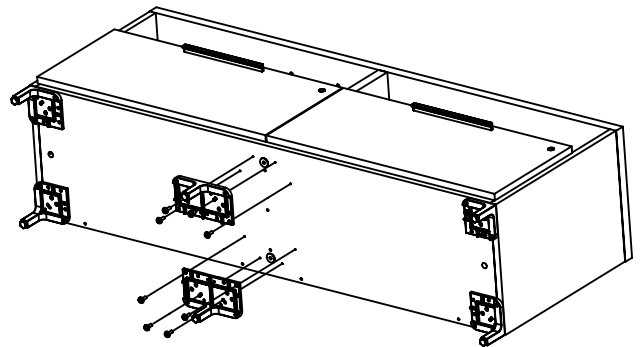
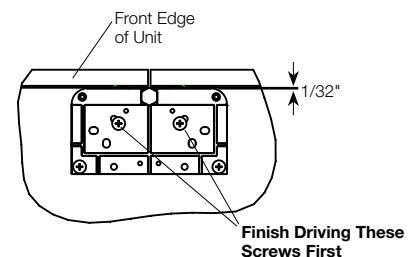

Fig. 5



Installing Feet on Ganged Units

- Follow steps 1-9 for installing feet on a single unit. (Note: only install (2) corner feet on opposite end of unit to be ganged as shown.) (Fig 6)
- Align middle foot to pilot holes on end of unit as shown. Drive (2) screws into pilot holes. (Note: Drive screws only partially to allow for adjustment.) (Fig 6)
- Ensure foot is aligned to front (or back) of unit as shown. Finish driving in the screw closest to the corner of the unit. (Fig 7)
- Finish driving remaining screw.
- Drill pilot hole for 3rd mounting screw as shown in figure 7. Drive 3rd screw into pilot hole.
- Align adjacent unit to the unit with feet installed as shown. (Fig 8)
- Clamp (2) units together making sure front edges align with one other. (Note: may require the removal of the bottom drawer(s) to clamp units together.) (Fig 8)
- Drive (2) screws into pilot holes on adjoining unit for front and back feet. (Fig 8)
- Drill pilot hole for 3rd mounting screw as shown in figure 7. Drive 3rd screw into pilot hole.
- Gang units together:
 - If unit has a bottom drawer, remove drawer if not already removed. Drill (2) pilot holes in drawer area approx. 10" up from the base and approx. 4" in from front edge and from back panel.
 - If units have no drawers, remove adjustable shelf and drill (2) pilot holes in line with shelf pin holes approx. 4" in from front edge and from back panel.
 - Screw 2 units together with (2) flat head screws. (Fig 9)
- Carefully rotate unit back into upright position.
- Level unit using adjustable glides on feet.

Fig. 6

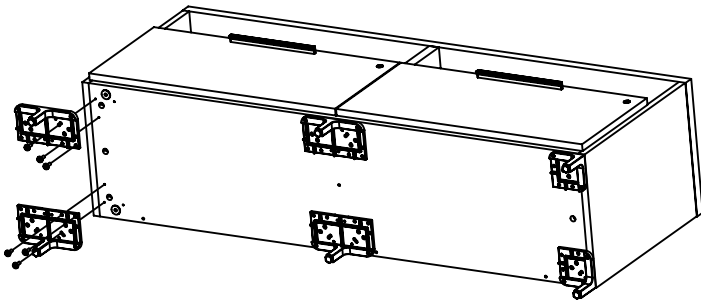

Fig. 7

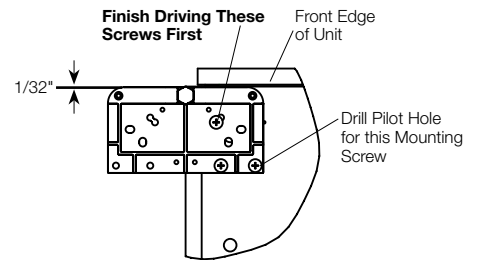

Fig. 8

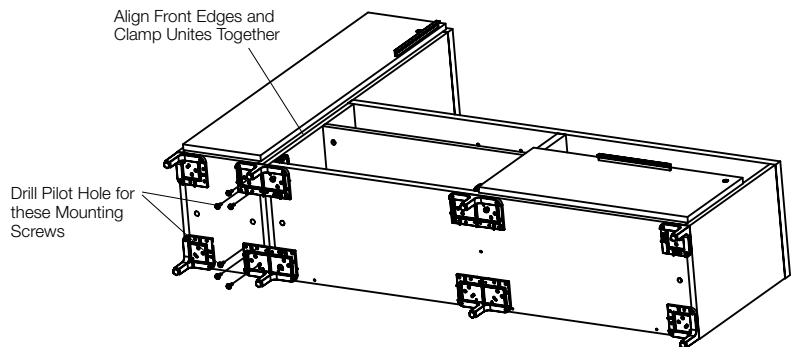

Fig. 9

