

# Dividends Horizon® End Of Run Infeed

1. Remove end trim and base raceway covers from the panel
2. Feed the infeed in from the end of the panel and pass the connector head through the large cutout in the panel's bottom rail. (One can also feed the conduit into the panel below the base raceway cover) (**Fig. 1**)
3. Secure the conduit to the bottom rail using the included strain relief clamp, the hex head bolt, and the wing nut (**Fig. 2**). Make sure that only the liquid tight conduit (black) is exposed outside the panel or touching the ground. Connect the jumper head to the power module inside the panel after all of the other electrical connections are made.

continued...

Fig. 1

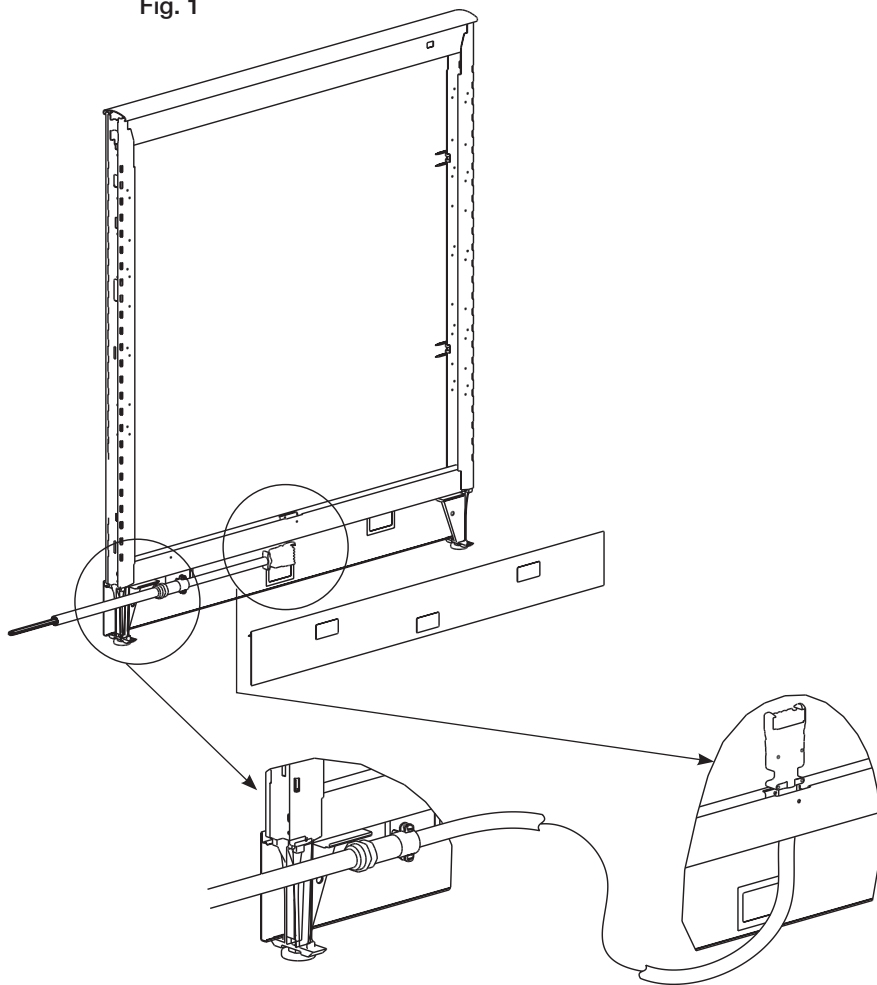
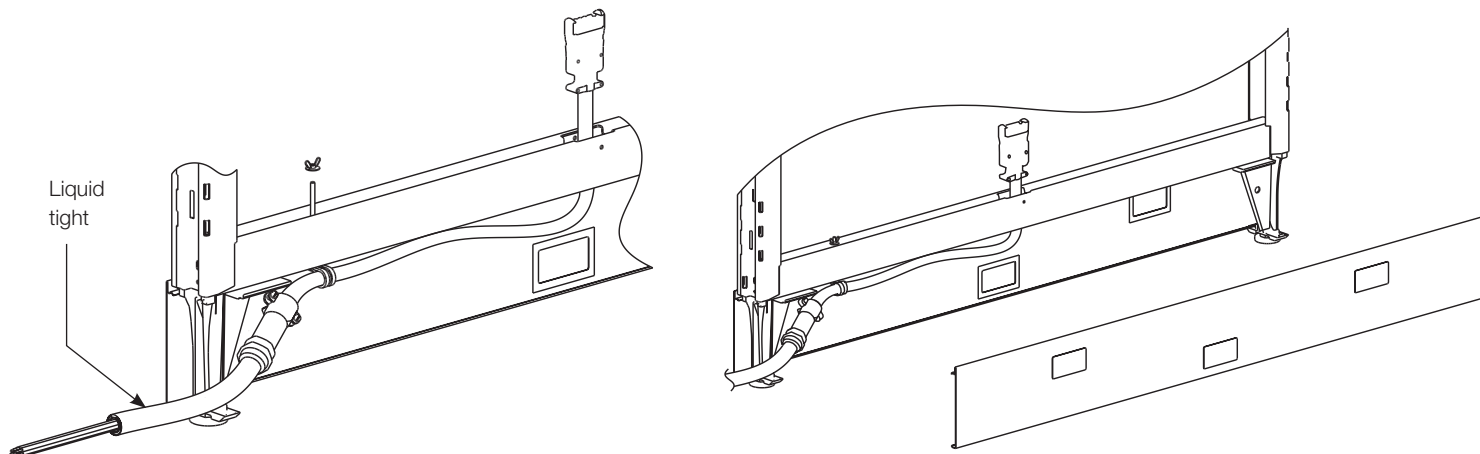
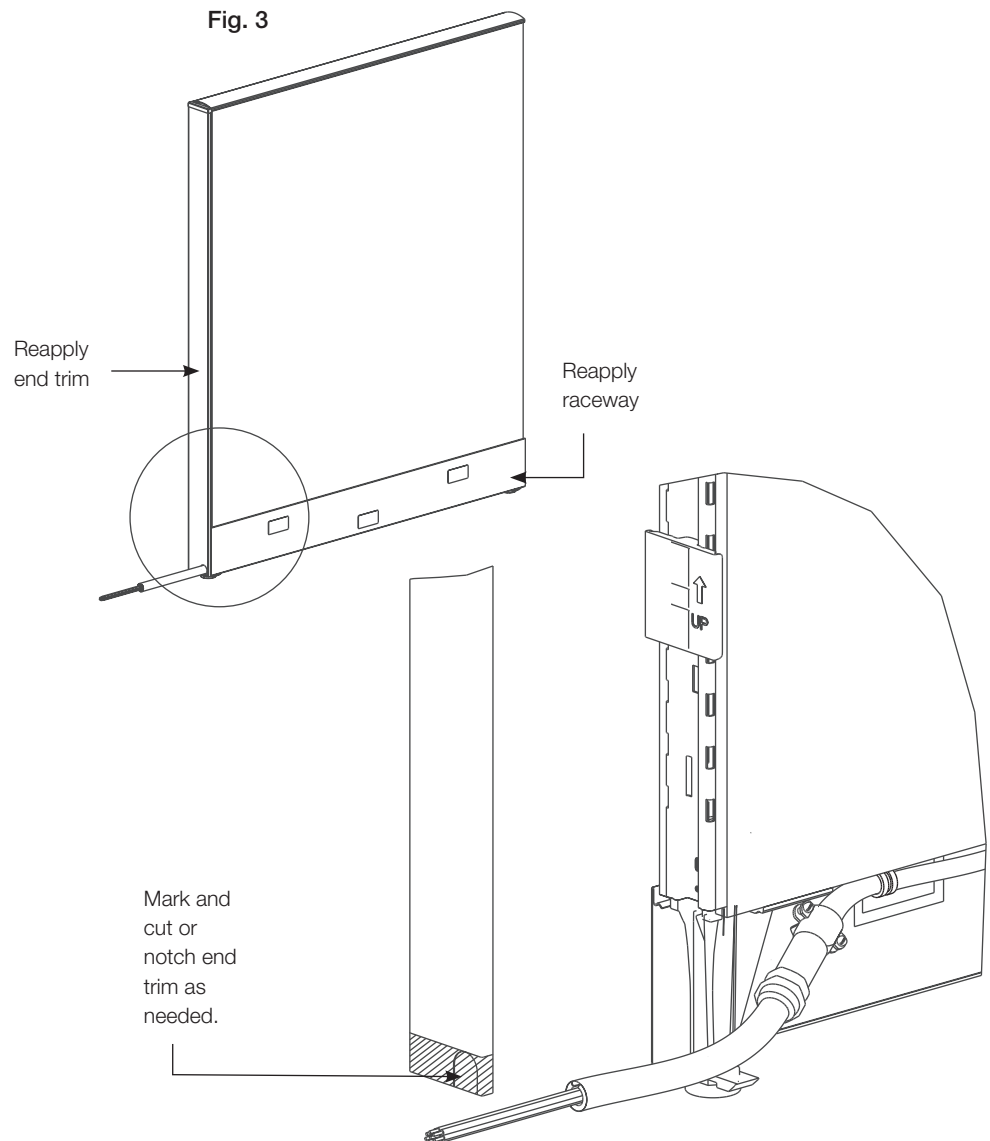

Fig. 2



## Dividends Horizon® End Of Run Infeed, continued

4. Replace the base raceway cover and panel tile.
5. Mark and notch or cut the end trim if needed.  
Reapply end trim to the panel. (Fig. 3)



### DISASSEMBLY FOR RECYCLING

#### Materials Identification and Segregation:

Where possible plastic components are marked with ASTM recycling codes. Use these codes to identify material type for recycling. Non-marked components should be treated as mixed plastic. Ferrous metals can be identified using a small magnet for recycling. Non-ferrous metals should be separated and recycled separately.

**To disassemble product,** reverse the above installation steps.