

Pop Up™ Easy Screen, Cardboard

1. Prepare

Clean worksurface with 50:50 IPA and water mixture and allow to completely dry to ensure best adhesion of the Velcro attachments on the bottom of the screens.

2. Unpack

Remove set of 3-piece surround from shipping box and separate the screen corners from the back panel. The back panel can be found inserted into one of the screen corner assemblies.

3. Chose a configuration

The corner pieces are 23" x 29" and can be configured in two ways on the worksurface: (A) 23"W x 29"L (A) or 29"W x 23"L (B). (Fig. 1)

Note: The screen corners are continuous on one side and have a relief cut on the other side. Corner screens are formed by folding the corner panel in on itself to form a 90-deg angle where the cutout section is inside, and the flat edges are outside.

The back panel screen is red on one side and brown on the other side. *The user should decide which color displays outward before assembly. This is difficult to change after assembly.*

4. Assemble the first corner

- + Fold the corner screen to form a 90-degree angle. (Fig. 2)
- + Peel off the backer on the Velcro tabs along the 3" base of the corner screen. (Fig. 2)
- + Align the corner screen flush with the outer edges of the worksurface. Press down firmly to adhere the screen to work surface. (Fig. 3)
Hint: It is best to do this one side (two Velcro tabs) at a time to ensure perfect alignment with the worksurface.

Continued...

Fig. 1

A
23" W x 29" L

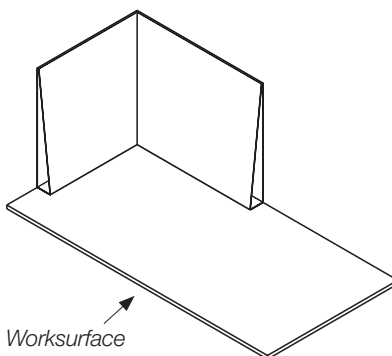

B
29"W x 23"L

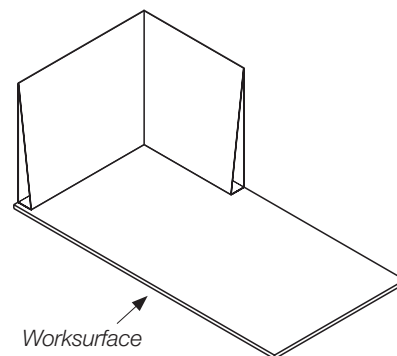
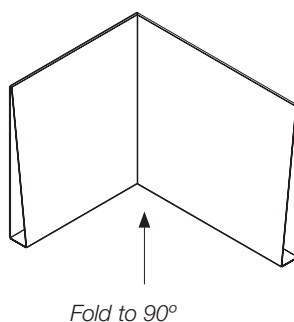

Fig. 2



Peel off Velcro backers

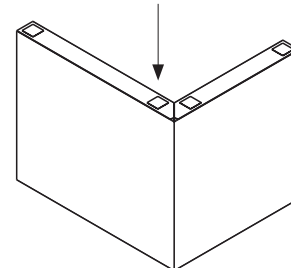
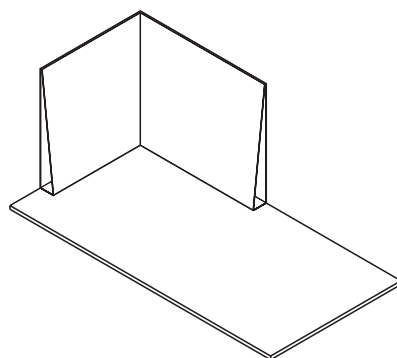
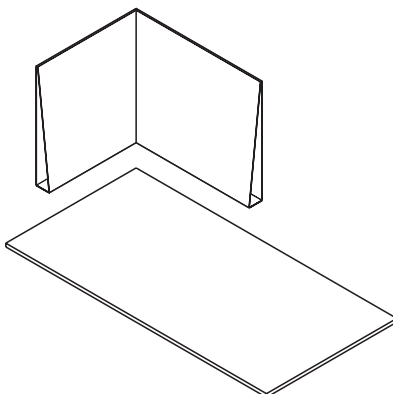

Fig. 3



Pop Up Easy Screen, Cardboard, continued

5. Assemble the back panel

Take back panel and fold to expose the color of choice. Fold the back panel tight together and slide it into the assembled corner, about half way. (Fig. 4)

6. Assemble the second corner

+ Fold the remaining corner screen and with two hands, fit the back panel into the remaining corner screen just as was done in steps 4 & 5. (Fig. 5)

+ Adjust the overlap between the two corners and the back panel until the screen surround assembly fits perfectly to the size of the worksurface, being flush with the outer edges.

+ Peel off the backer on the Velcro tabs along the 3" base of the corner screen. (Fig 6.) While maintaining alignment, press down firmly to adhere the corner screen to worksurface. *Hint: It is best to do this one side (Two Velcro tabs) at a time to ensure perfect alignment with the worksurface.*

Fig. 4

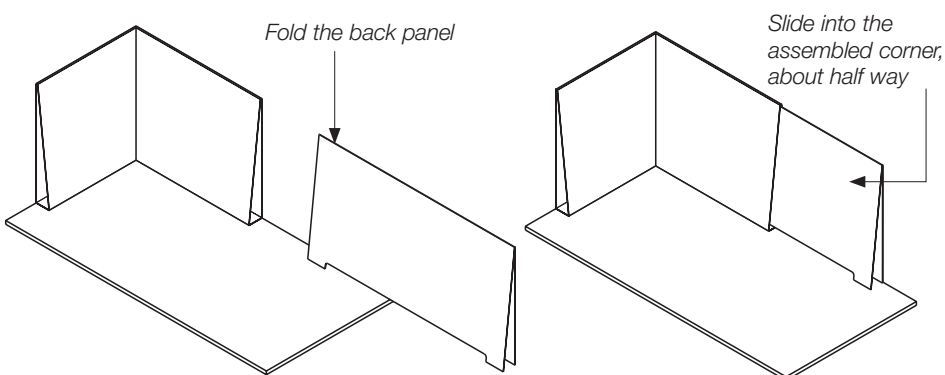

Fig. 5

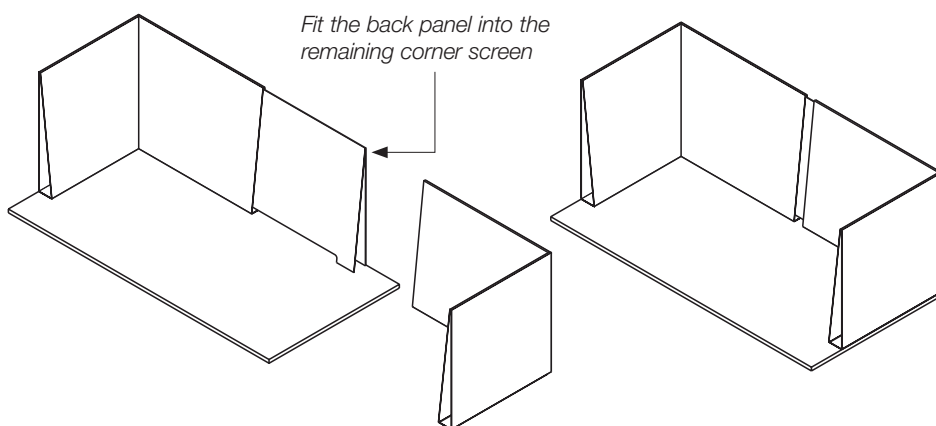

Fig. 6

