

Electrical - Power Square

Reference Number: 6TD00043

1. Prepare Power Square for Assembly

(Fig. 1)

Disassemble the power square into components as shown in Fig. 1.

Note: Do not remove the thumb screws, item (A) from the lock bracket item (C) unless the power square is for use in any X-Base table.

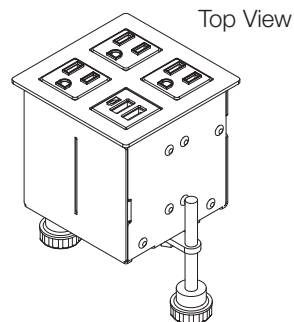
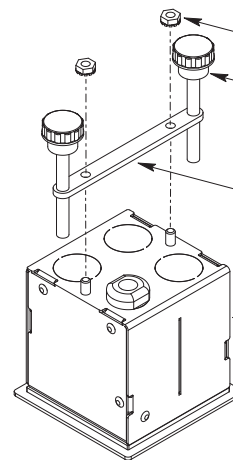
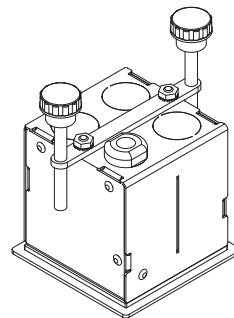
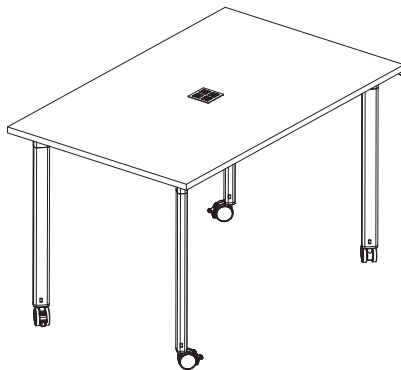

Fig. 1

Components

- (B) Lock nut
- (A) Thumb screw
- (C) Straight-bracket
- (D) Power square

All tables - except X-Base conference tables
(see installation on sheet 2)



X-Base conference tables
(see installation on sheet 3)

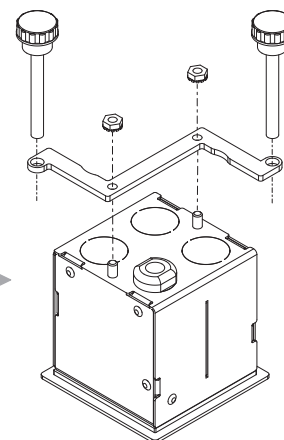
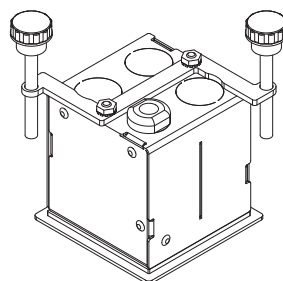

- (E) Z-bracket
use with X-Base
conference tables

Disassembled power square ready for installation

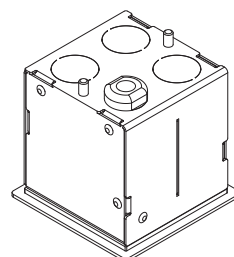

Electrical - Power Square

Reference Number: 6TD00043

2. All tables (except X-Base conference tables) (Fig. 2)

Note: Table top surface must be accessible for installation into X-Base tables. Skip to Step 3.

- 2.1 Place disassembled power square onto the top surface of the table and into the cut-out. The top lip of the unit should seat itself squarely against the surface.
- 2.2 From underneath the worksurface, align the straight-bracket (C), with the studs on the power square and secure in place with the provided lock nuts (B).
- 2.3 Tighten the thumb screws (A) until snug against the surface. Do not over tighten.

Fig. 2

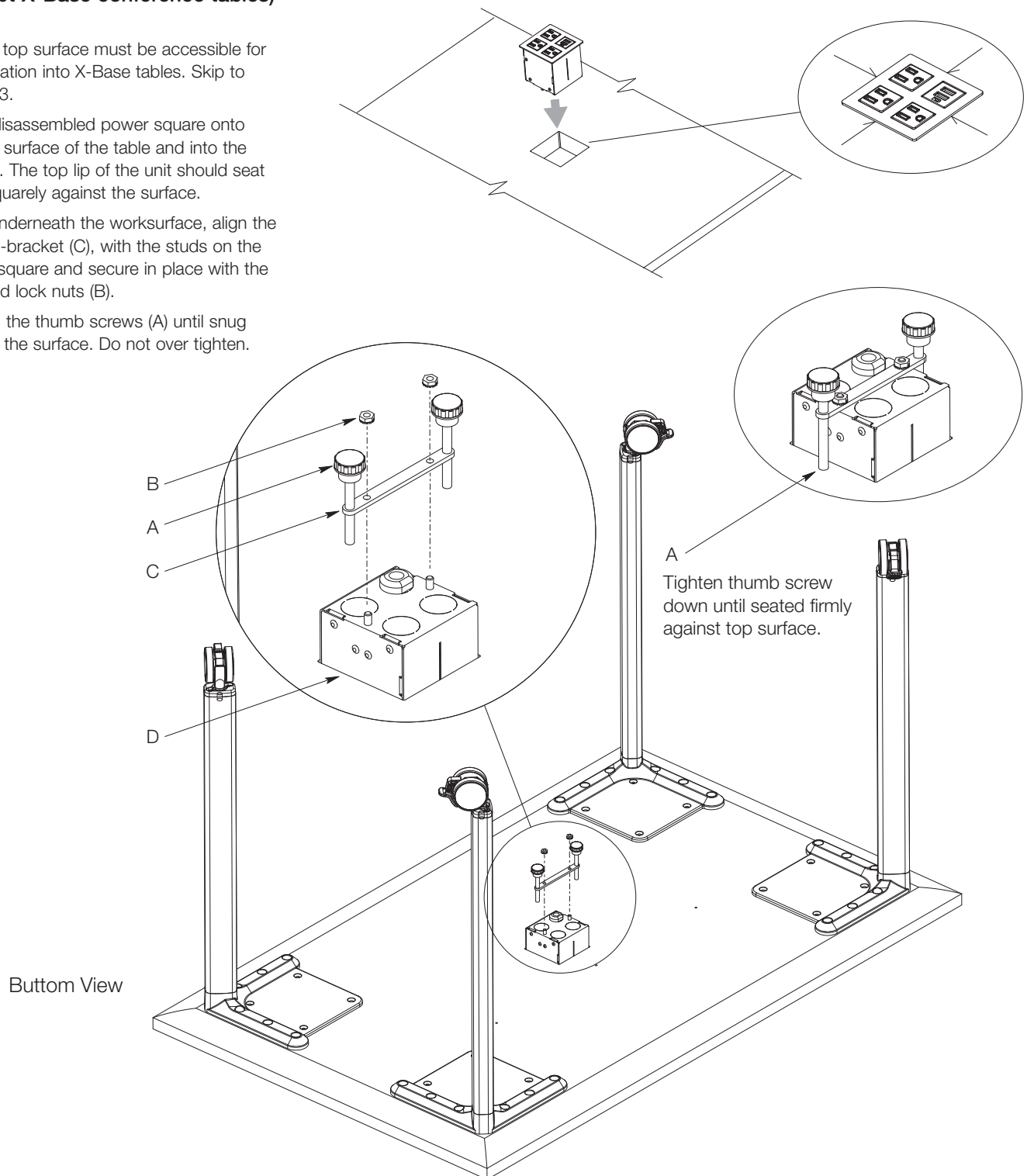

Electrical - Power Square

Reference Number: 6TD00043

3. X-Base conference tables

(Fig. 3)

- 3.1 Place disassembled power square onto the top surface of the table and into the cut-out. The top lip of the unit should seat itself squarely against the surface.
- 3.2 From underneath the worksurface, align the Z-bracket (E) with the studs on the power square by fishing through opening in base cone and secure in place with the provided lock nuts (B).
- 3.3 Tighten the thumb screws (A) into the holes in Z-bracket (E) until snug against the surface. Do not over tighten.

Fig. 3

