

Rockwell Unscripted®

Backdrop Mobile Markerboard Wall

Designed by
Rockwell Group



Rockwell Unscripted
Backdrop Mobile Markerboard Wall

Backdrop sets the scene for collaboration. With multiple whiteboard surfaces and integrated storage, Backdrop facilitates team work while also creating ad hoc delineation when opened. Designed to let your story unfold in any setting; a team neighborhood, a creative studio, or a conference room.

- A** Backdrop comes with one set of shelves (one upper shelf shown); additional shelves ordered separately and positioned anywhere along the vertical
- B** Grommet at bottom of unit provides a pass through for a plug strip when placed on shelves
- C** Oversized casters allow for smooth transitions
- D** Handles on the doors offer easy access to interior; each door features a magnetic catch

Warranty
5 Years

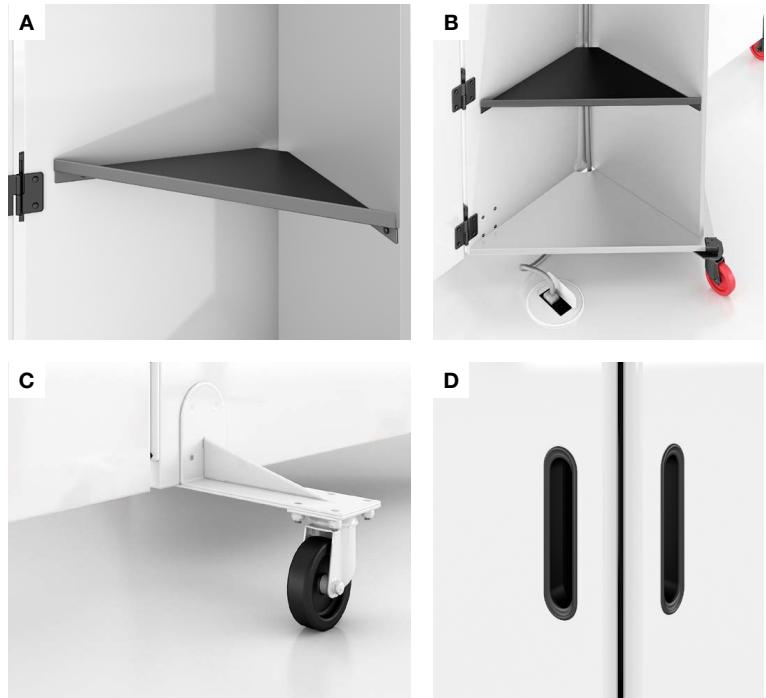

STATEMENT OF LINE

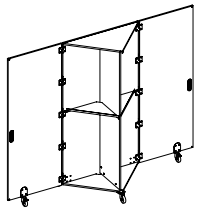

with Open Doors
W: 104"
D: 35"
H: 85"

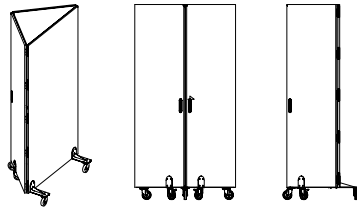

with Closed Doors
D: 35"
H: 85"
Exterior Center Markerboard
W: 44"
Exterior Side Markerboard Doors
W: 30" each

TECHNICAL INFORMATION

- + Entire unit weights 240lbs.
- + Each interior shelf can support up to 35lbs.
- + Doors open 180°

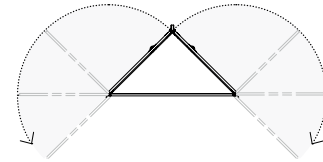

FINISHES

Please visit knoll.com/surface-finish-library to view all finishes and swatches.

Exterior



Interior

(Edgeband will match interior laminate; any laminate can be paired with markerboard)

- Markerboard laminate
- Bright White
- Folkstone Grey
- Fog
- Medium Grey
- Jet Black
- Brushed Sand
- Micro Sand
- Micro Grey
- Soft Grey
- Pumice

Shelf

- Bright White
- Folkstone Grey
- Medium Grey
- Jet Black

Handle and Hinges

- Bright White
- Jet Black

Casters

