

Add Up Screens – Frameless Trim

Pattern Numbers Represented

YPAUS----FL

YPAUT----FL

YPAUE----FL

Parts List

(A) 3AJ4217 Top Trim

(B) 3AJ4215 Vertical Trim

(C) 3AJ0379 Frameless Base Extrusion

Tools Needed

1 Loctite 454 adhesive 3 gram tube

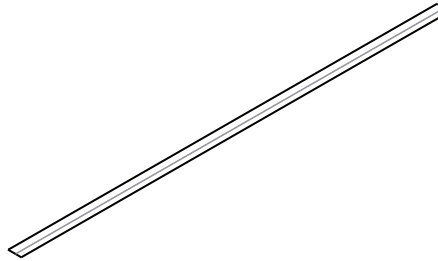

(A) 3AJ4217



(B) 3AJ4215

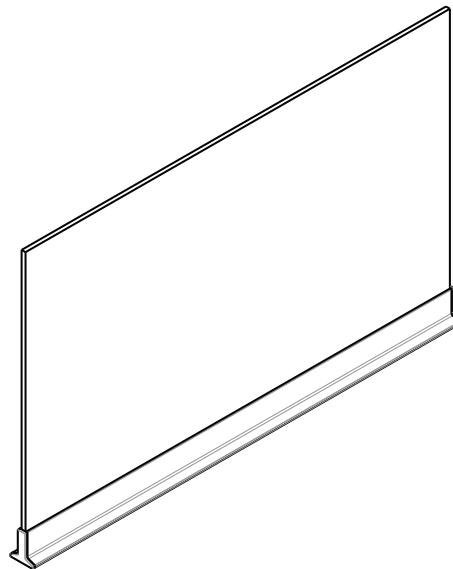

(C) 3AJ0379

DISASSEMBLY FOR RECYCLING

Materials Identification and Segregation:

Where possible plastic components are marked with ASTM recycling codes. Use these codes to identify material type for recycling. Non-marked components should be treated as mixed plastic. Ferrous metals can be identified using a small magnet for recycling. Non-ferrous metals should be separated and recycled separately.

To disassemble product, reverse the above installation steps.

Add Up Screens – Frameless Trim, continued

Assembling Add Up to Base Screen

1. Attach the add up screen assembly (C) to the base screen by removing the VHB tape backing sheet from the base of the screen, lowering the add up screen (C) onto the base screen and pressing the add up screen down onto the base screen – holding in place for couple of second.

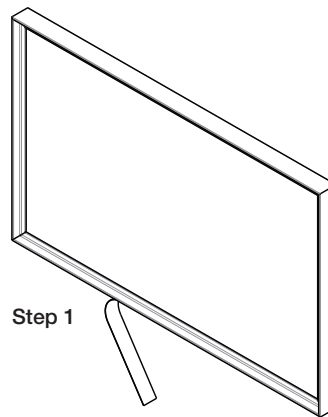

Step 1

Applying Optional Trim

2. Find the correct trim for application (end, intermediate or stand along screen). Trim is optional for all applications except corrugated plastic which requires top trim.

- 2.1 First apply end vertical trim. Set vertical trim (B) down U-shaped channel up. Apply a 2-3 drops of Loctite 454 glue inside the U-shaped channel in 3 inches intervals starting 1-inch from the end of the trim. **Do not use too much glue, keep the drops uniform size, avoid glue runs.** Place the bottom of the side trim on top of the end cap (make sure the mitered end is up) and press it onto the add up screen material. Hold in place for 10-15 seconds.

- 2.2. Located top trim (A). Set trim down with U-channel up, apply glue inside the trim U channel in 3-inch intervals starting 1-inch from the end of the trim. Align the mitered corner and slowly push the top trim (A) down on the top edge of the add up material. Hold down for 10-15 seconds.

- 2.3 If stand alone screen, repeat **step 2.1** for other vertical end of add up screen.

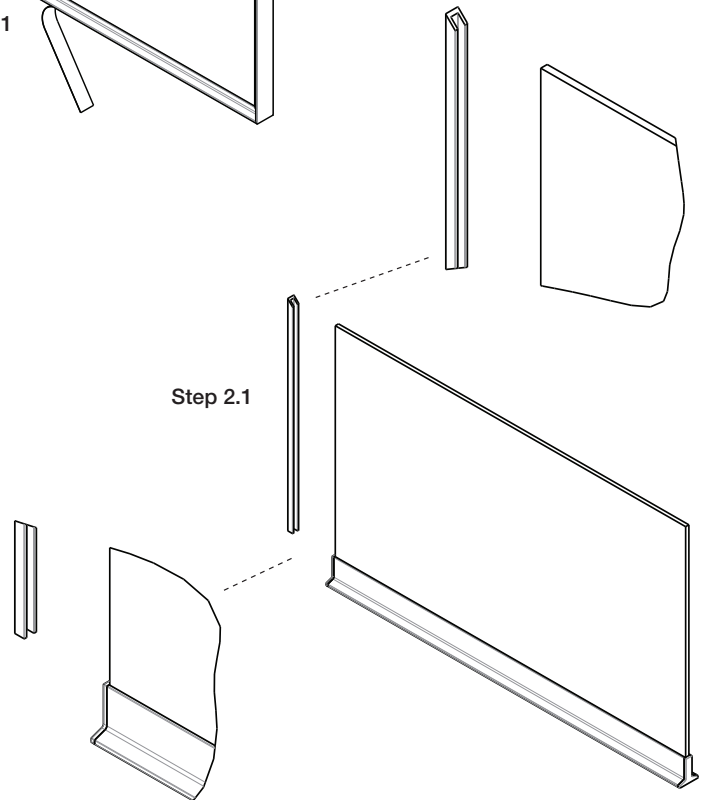

Step 2.1

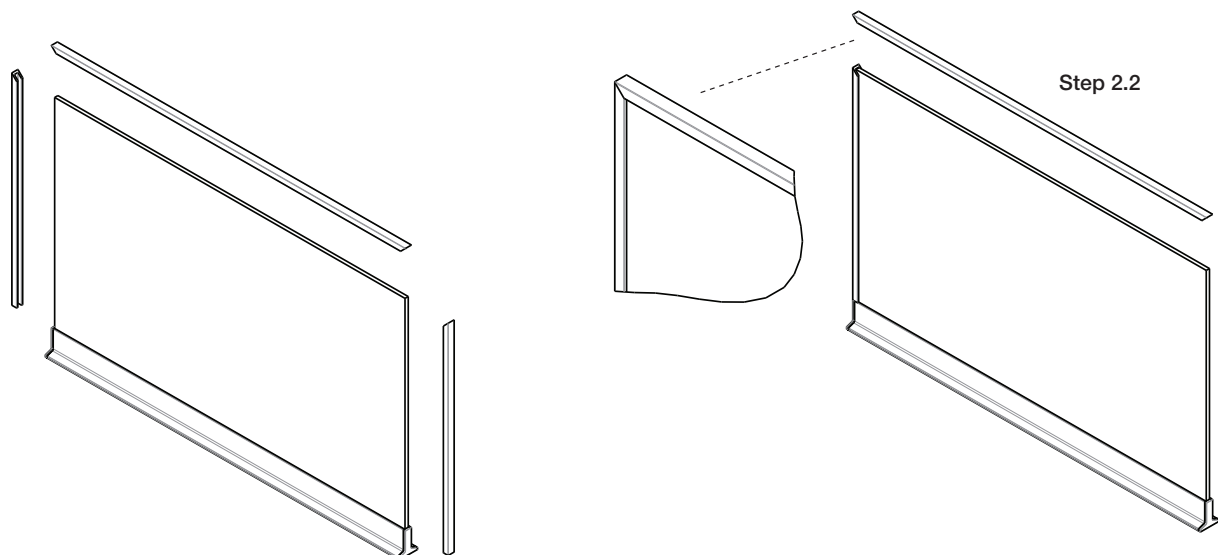

Step 2.2