

Saarinen Coffee Tables

Marble Tops

2 Installers Required

162TR – 35" Round

162TO – 42" Oval



For step-by-step video
instructions, visit knoll.com



Knoll, Inc
1235 Water Street
East Greenville, PA 18041

Saarinen Coffee Tables

Hardware

(3) M8 X 16MM slotted machine screws
**included in base carton*

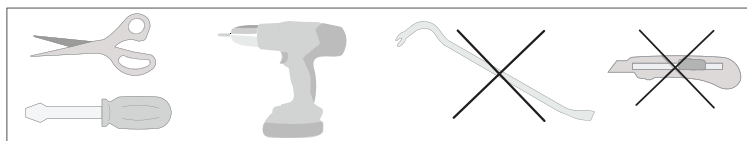

Tools

Scissors

Slotted screwdriver

Driver *(for use on marble crate only)*

T20 torx bit

CAUTION: DO NOT REPLACE SCISSORS WITH AN X-ACTO KNIFE AS SCRATCHES CAN OCCUR

Unpacking top and base cartons

A MINIMUM OF (2) INSTALLERS ARE REQUIRED FOR PROPER TABLE ASSEMBLY. ALL MARBLE TOPS MUST REMAIN IN CRATE UNTIL DELIVERY AT INSTALLATION SITE. TOP SHOULD REMAIN IN A VERTICAL POSITION DURING STORAGE AND TRANSPORT. BE SURE TO ASSEMBLE THE TABLE IN THE DESIRED SPACE IT WILL BE USED IN; AVOID MOVING THE TABLE ONCE TOP AND BASE HAVE BEEN ASSEMBLED.

1. The coffee table will arrive in two packages: a wooden crate containing the marble top and a box containing the base and hardware. Begin by unpacking the base carton. Using scissors, open the box and carefully remove the table base and bag of hardware, set aside.
2. Begin breaking down the marble crate by placing it flat on the floor. One installer uses driver to remove the four corner screws and the crate face. Marble top should remain in the opened crate on floor with the underside facing up in preparation for the following steps.

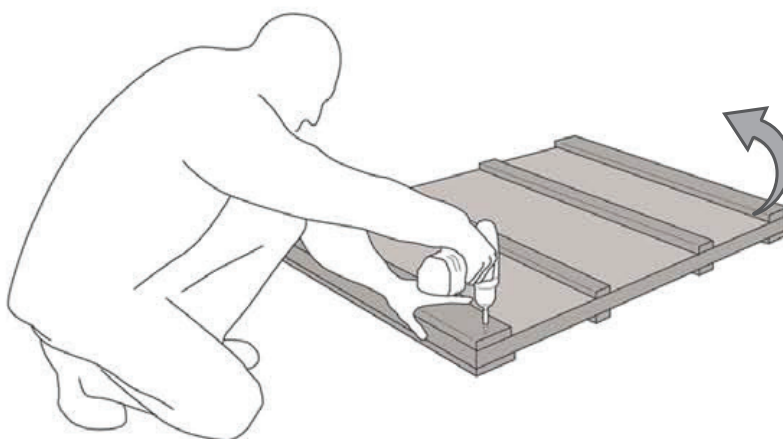

Saarinen Coffee Tables

Screwing the top and base together

3. Pick up table base and carefully line up the three predrilled holes on the subtop to the three inserts on the underside of the marble top.
4. Using a slotted screwdriver, screw the (3) M8 X 16MM screws into the inserts on the marble top until they make contact and then tighten an additional ¼ turn.

CAUTION: OVERTIGHTENING CAN CAUSE DAMAGE; ALWAYS USE A SCREWDRIVER NOT A DRIVER OR POWER DRILL

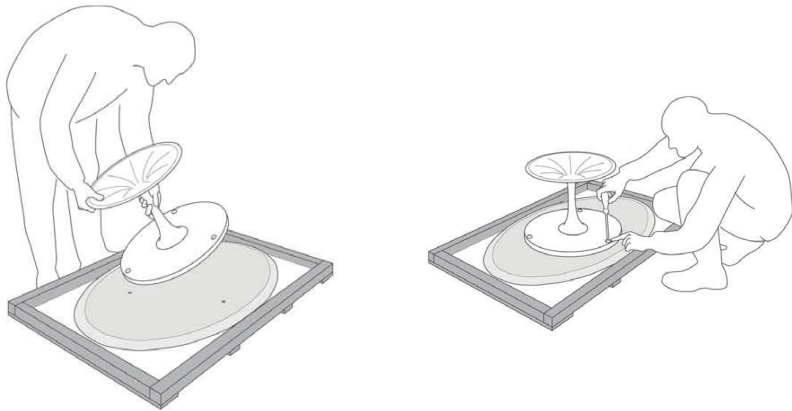

Placement of coffee table

5. Two installers carefully lift the table from opposite sides of the marble out of the open crate. Carefully rotate table to be top side up and place on desired spot on floor.

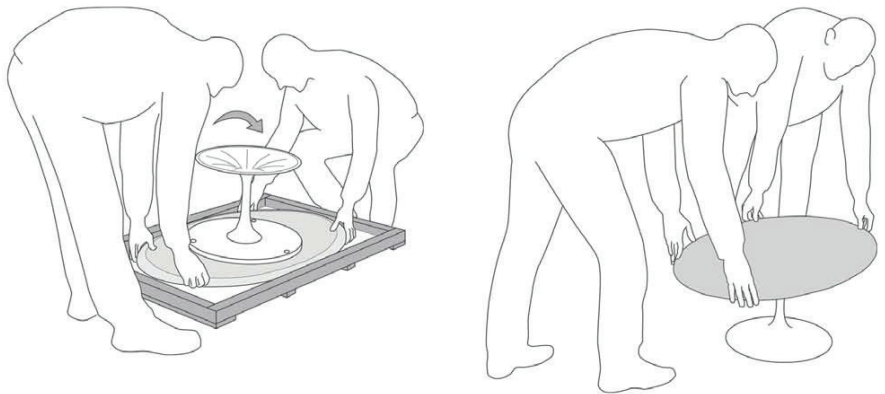

Moving the table

6. Never move the table by the top only. The table should be assembled in its final location. If the table's position must be adjusted slightly, you may carefully move it a few inches by grasping the stem of the base and sliding the table into the desired position. If the table needs to be moved any distance greater than a few inches, the table must be disassembled.