

k. screen Contour in PET Installation:

Contour in PET screens are available with various screen configurations and five different mounting bracket options. This guide has five sections, providing instruction for the five bracket types.

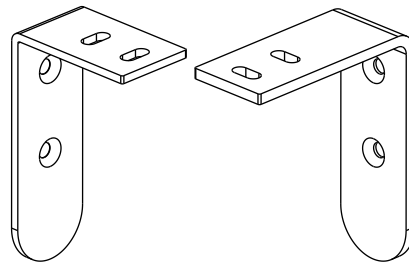

Economy Undermount (Pg. 2)

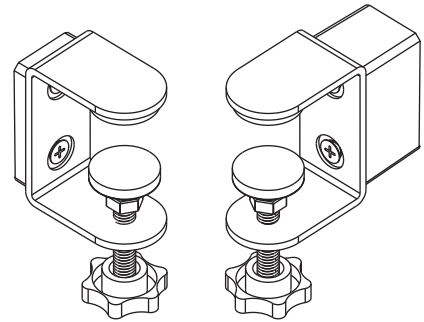

Economy Clampmount (Pg. 4)

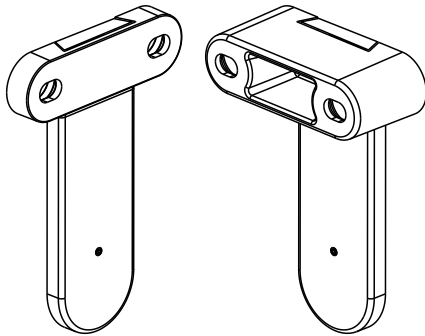

Premium Edgемount (Pg. 6)

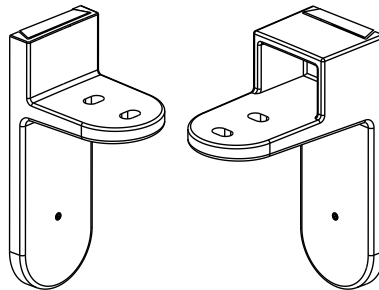

Premium Undermount (Pg. 10)

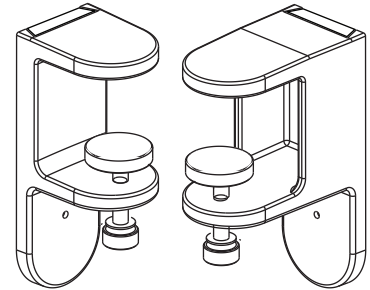

Premium Clampmount (Pg. 13)

Appendix A provides bracket location dimensions for the various types of screens shown below (Pg. 16). Bracket location dimensions for Radiused Surround Screens depend upon the width of the Top. Be sure to reference the correct table in Appendix A.

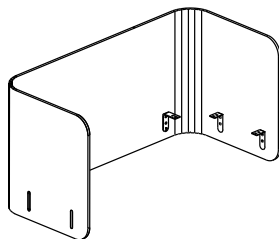

Radiused Surround Screen

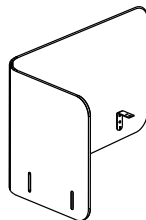

J-Shaped Screen

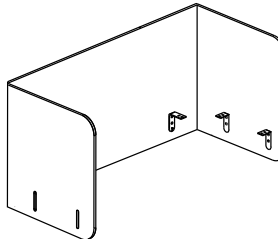

Rectangular Surround Screen

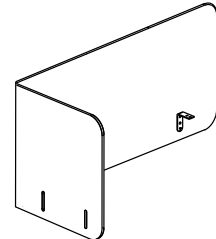

L-Shaped Screen

DISASSEMBLY FOR RECYCLING

Materials Identification and Segregation:

Where possible plastic components are marked with ASTM recycling codes. Use these codes to identify material type for recycling. Non-marked components should be treated as mixed plastic. Ferrous metals can be identified using a small magnet for recycling. Non-ferrous metals should be separated and recycled separately.

To disassemble product, reverse the above installation steps

k. screen Contour in PET Installation

All PET Screens with Economy Undermount Brackets, KSUJEU __ KSULEU __ KSJEU __ KSLEU __

Parts List



Outer Clamp
Bracket (A)
3AJ4280

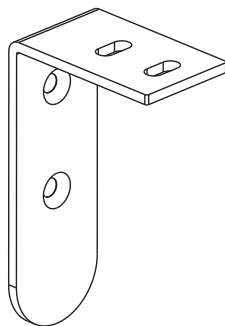

Side Bracket (B)
3AJ4278

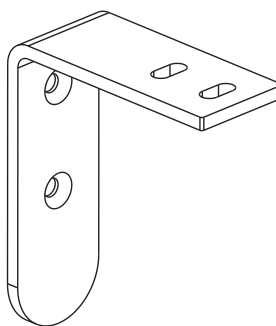

Back Bracket (C)
3AJ4279

Tools Needed:

Tape Measure and pencil
Power Driver with #2 Phillips Bit



#8 x 1" Type
A Truss Head
screws (D)
4A22304



#10-24 x 3/8"
Screws (E)
4A21859

Economy Undermount Installation

1. Review the dealer-supplied installation documents to identify the size and placement of the k. screen to be attached to the worksurface. Match the size and configuration (Radiused Surround, Rectangular Surround, J-Shape or L-Shape) to the appropriate Installation Appendix A table to determine the required bracket locations.

2. Mark the underside of the top for each bracket location. Ensure the mark extends at least 1-1/2" from the edge (Fig. 1).

3. Mark screw locations. At each bracket location mark 5/8" and 1-3/8" from the edge (Fig. 1)

4. For two back bracket locations, align a bracket (C) to the marks and attach by driving the (2) #8 x 1" Type A Truss Head screws (D) centered in the bracket slots (Fig. 2).

Fig. 1

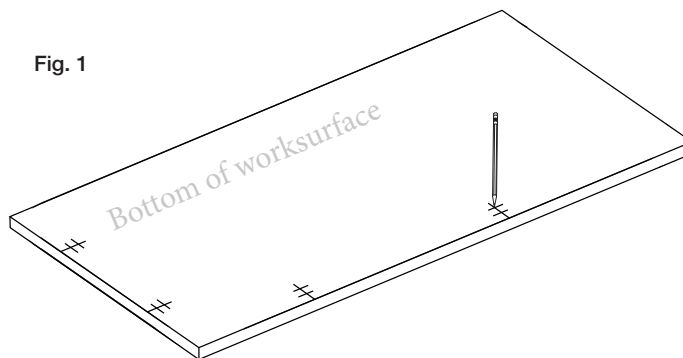
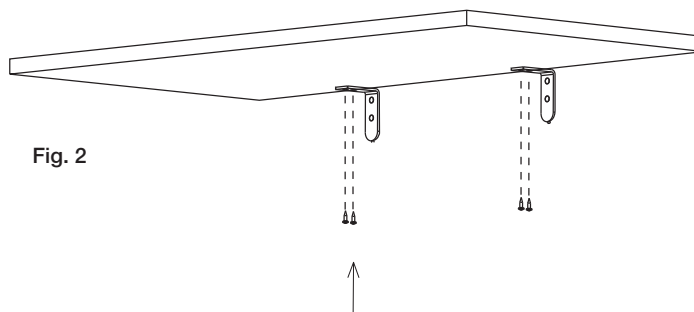

Fig. 2



PET Screens with Economy Undermount Brackets Installation, continued

Economy Undermount Installation

Panel Preparation

5. On the exterior of the PET panel, Insert an Outer Bracket (A) into each rectangular bracket slot, oriented so the holes are in the upper portion of the slot.

Warning: Do not use impact driver to tighten machine screws in Steps 6 and 7

6. Attach side brackets (B) to the side face of the panel using (2) #10-24 x 3/8" Screws (E) for each bracket (Fig. 3).

Attach Panel to Top

7. Hold the screen panel against the two back brackets and attach using (2) #10-24 x 3/8" Screws (E) for each bracket (Fig. 3).

8. Hold side of panel so that it is 3/8" from worksurface edge. Position forward side bracket so marks on underside of top are visible through slots. Start driving each screw where the marks cross, and secure using (2) #8 x 1" Type A Truss Head screws (D) (Fig. 4).

9. Attach remaining brackets in the same way.

Fig. 3

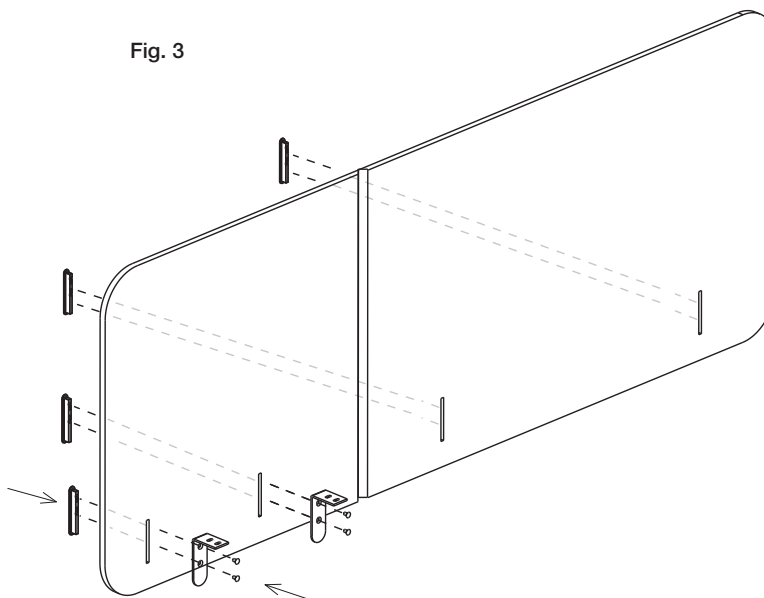
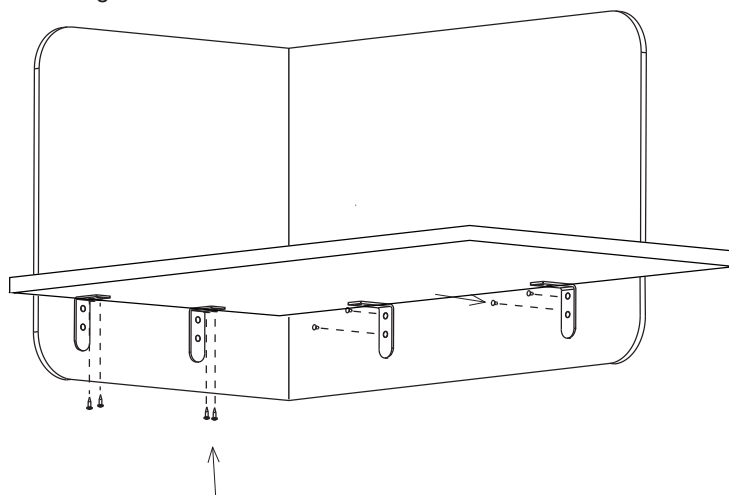

Fig. 4



k. screen Contour in PET Installation

All PET Screens with Economy Clamprmount Brackets, KSUJEC__KSULEC__KSJEC__KSLEC__

Parts List



Outer Clamp
Bracket (A)
3AJ4280

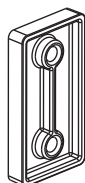

Side Spacer
(B) 3AJ4297

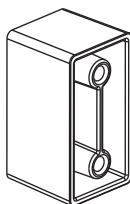

Back Spacer
(C) 3AJ1258

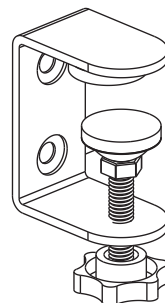

Clamp Assembly (D)
3AJ1259

Tools Needed:

#2 Phillips Screwdriver
#2 Phillips hex bit
Right-angle hex bit ratchet



#10-24 x
5/8" Flathead
screws (E)
3AJ4298

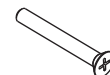

#10-24 x
1-1/2" Flat-
head screws
(F) 3AJ4287

Economy Clamprmount Installation

Panel Preparation

1. On the exterior of the PET panel, Insert an Outer Bracket (A) into each rectangular bracket slot, oriented so the holes are in the upper portion of the slot (Fig. 1)

Warning: Do not use impact driver to tighten machine screws in Step 2.

2. Assemble the clamps to the inside face of the panel. For back bracket locations place the 1" thick spacer (C) against the face of the outer bracket (D) so that the projections insert into unthreaded holes, place the clamp body against the spacer (with clamp knob toward bottom of screen panel.) Secure in place using (2) #10-24 x 1-1/2" Flathead screws (F). For the lower screw, adjust the clamp stem to advance the clamp pad past the screw hole to make room for Phillips hex bit and your fingers. Tighten screw finger tight with just the hex bit, then use right angle ratcheting bit driver to fully tighten.

For side brackets repeat this same procedure, with the thin spacer (B). Secure using (2) #10-24 x 5/8" Flathead screws (E).

3. Adjust all clamps to fit loosely on the top (Fig. 2).

Fig. 1

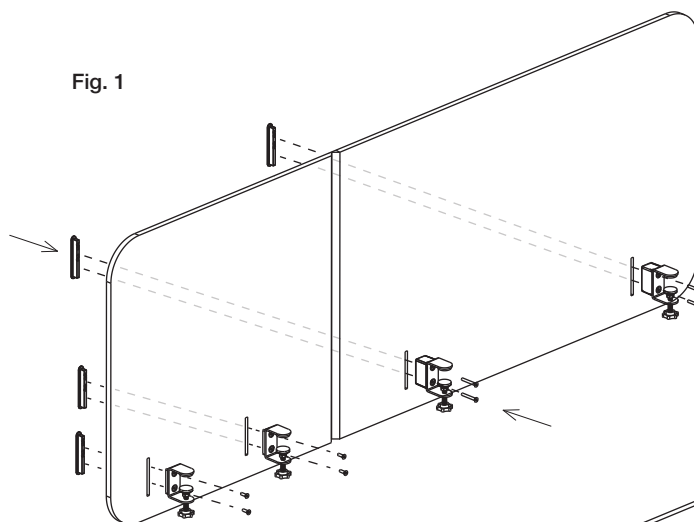
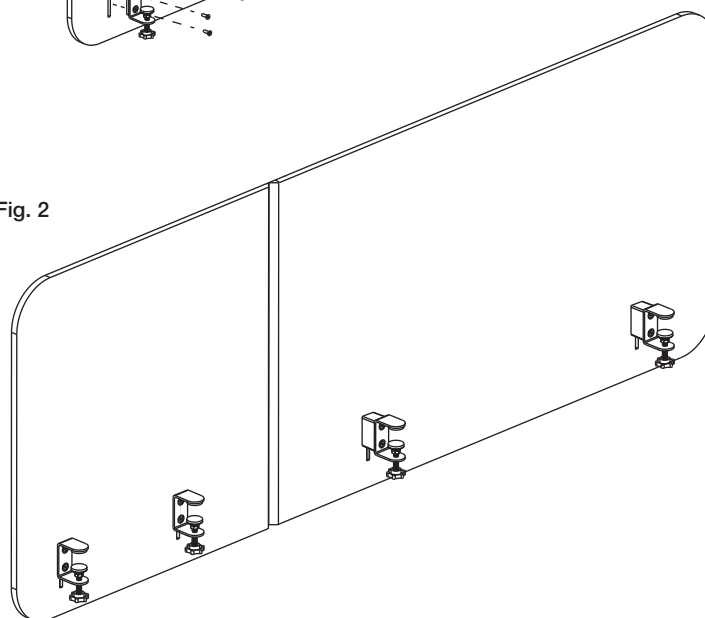

Fig. 2



PET Screens with Economy Clampmount Brackets Installation, continued

Attach Panel to the Top

4. With all the clamp brackets (D) attached to the panel, place the panel onto the worksurface by resting the top flange of each clamp bracket atop the worksurface (Fig. 3).

5. Lightly tighten each clamp by turning the clamp knob finger-tight or less, securing the screen to the top.

6. Adjust the clamp locations on the top per dimensions in the appropriate Table in Appendix A. Fully tighten all clamps.

Fig. 3

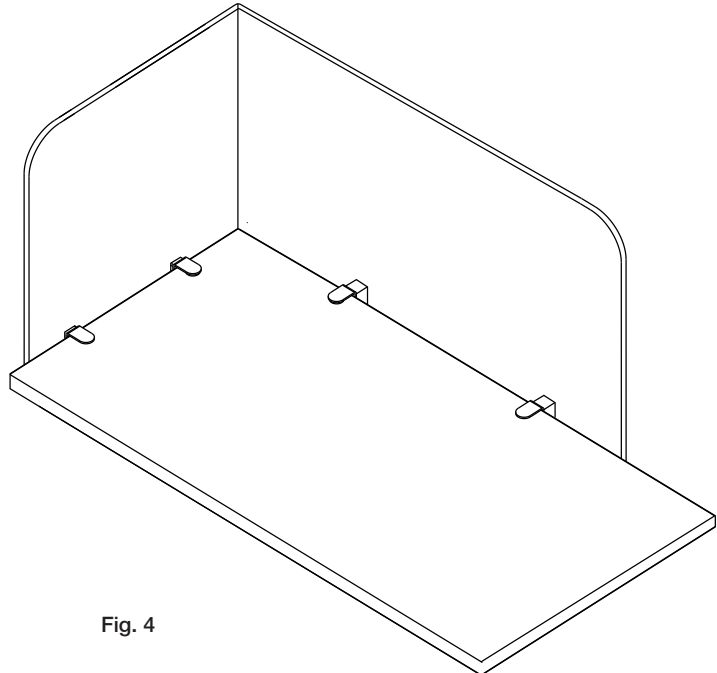
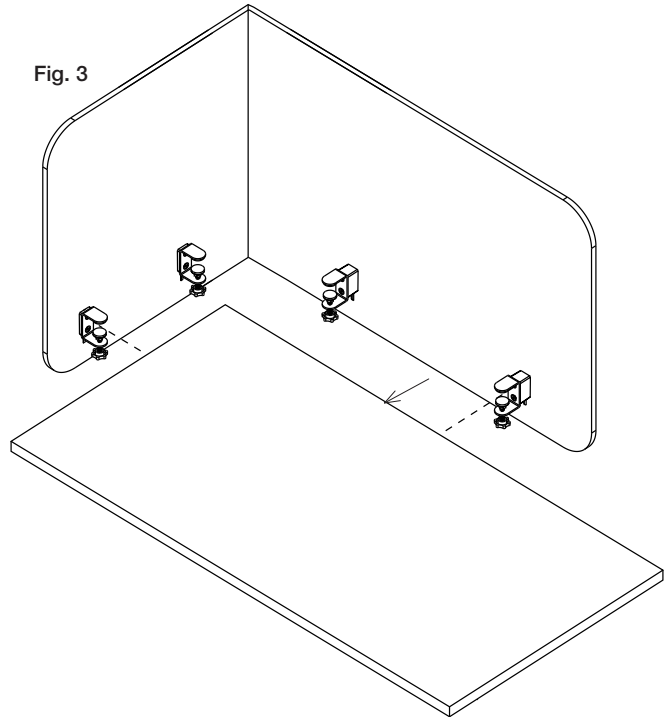

Fig. 4

k. screen Contour in PET Installation

All PET Screens with Premium Edgemount Brackets, KSUJPE__ KSULPE__ KSJPE__ KSLPE__

Parts List



Outer
Bracket (A)
3AJ4252



Inner Bracket (B)
3AJ4299

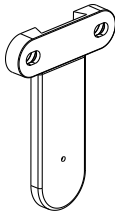

3/8" Side Bracket (C)
3AJ4301

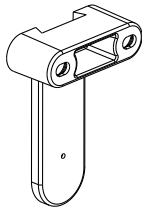

1 1/4" Back Bracket (D)
3AJ4302

Tools Needed:
Tape Measure and pencil
Installation Guide
Drill
9/64" Drill Bit
#2 Phillips Screwdriver
#3 Phillips Screwdriver
1/16" Allen Wrench



8-32 x 3/8"
Truss Head
Machine Screw
(E) 3AJ4303



#14 x 1" Flat Head
Sheet Metal Screw
(F) 7434100



6-32 x 1/4" Set Screw
with extended tip (G)
3AB1623

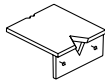

Installation Guide (H)
3AB4496
(Sold Separately)



Cap (I) 3AJ4300

Premium Edgemount Installation

1. Review the dealer-supplied installation documents to identify the size and placement of the k. screen to be attached to the worksurface. Match the size and configuration (Radiused Surround, Rectangular Surround, J-Shape or L-Shape) to the appropriate Installation Appendix A Table to determine the positions of required worksurface edge drillings. The Installation Guide (H) should be placed on top of the worksurface, pressed against the edge, centered on the listed dimensions. Two holes are to be marked on the worksurface edge for each guide position.

PET Screens with Premium Edgemount Brackets Installation, continued

Attach Brackets to Top

2. Pre-drill the marked hole locations with a 9/64" drill bit. This step must not be skipped, regardless of edgebanding material. Note: veneer edgebanding will split if not pre-drilled appropriately. Holes should be pre-drilled to depth. (Fig. 1)

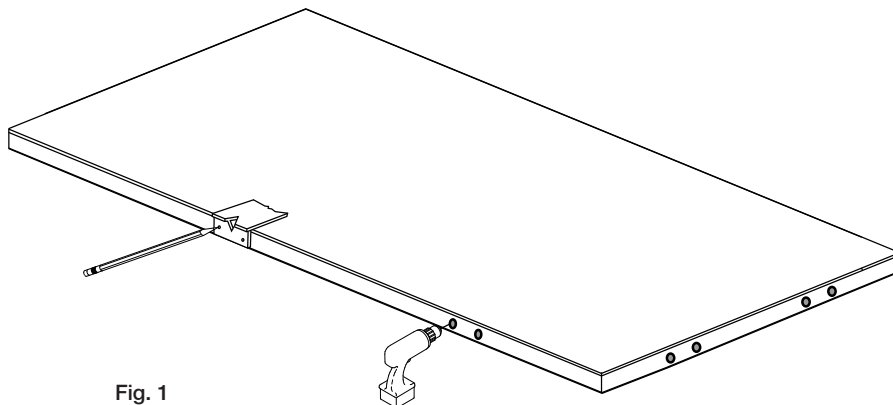

Fig. 1

3. Note the difference in thickness between the 1 1/4" Back Brackets (D) and the 3/8" Side Brackets (C). Align the Back Brackets (D) to the pre-drilled holes along the back edge. Attach the brackets to the worksurface using (2) #14 x 1" Flat Head Sheet Metal Screws (F) per bracket. (Fig. 2)

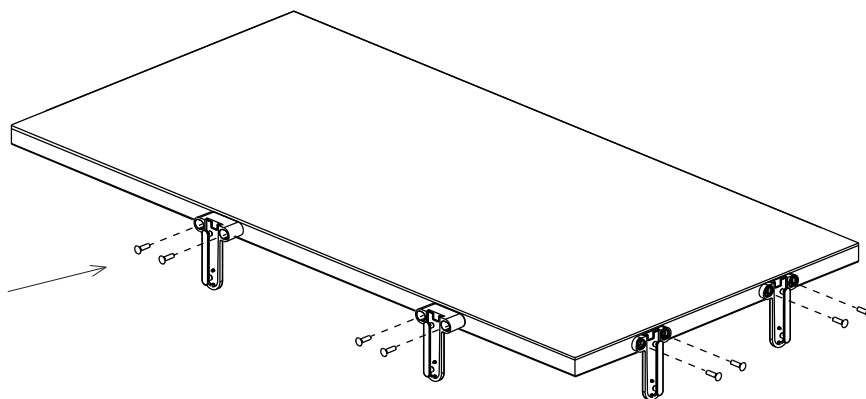

Fig. 2

PET Screens with Premium Edgemount Brackets Installation, continued

Panel Preparation

4. On the exterior of the PET panel, Insert an Outer Bracket (A) into each rectangular bracket slot (Fig. 3).

Warning: Do not use impact driver to tighten machine screws in Step 5.

5. On the interior side of the PET panel, attach an Inner Bracket (B) to the Outer Bracket at each location using (2) #8-32 x 3/8" Truss Head Screws (E).

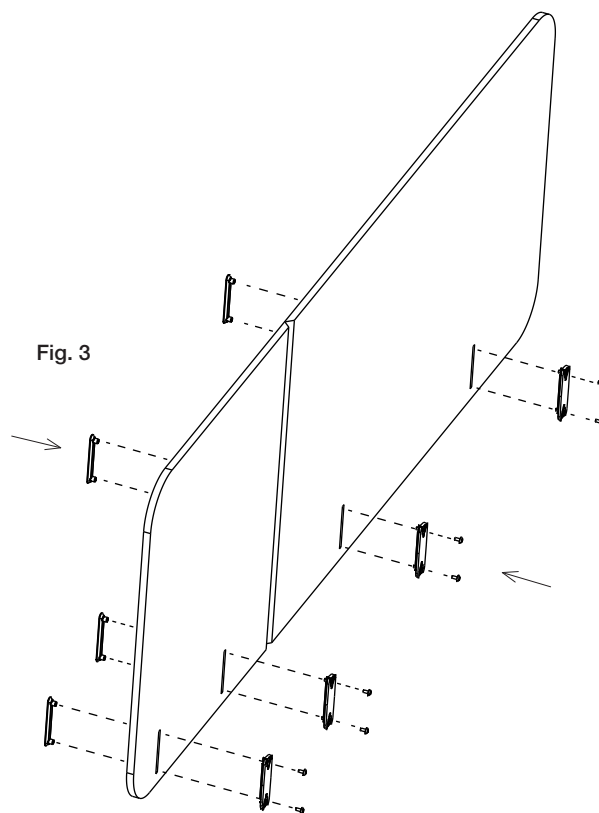

Attach Panel to the Top

6. Connect the screen to the Desk Brackets (C/D), by sliding the Inner Brackets (B) down, vertically, into the desk brackets. All of the brackets will need to be guided down at the same time. The holes in the Side and Back Brackets are elongated to allow side-to-side adjustment and to ensure inner brackets can be fully seated; adjust as needed (Fig. 4).

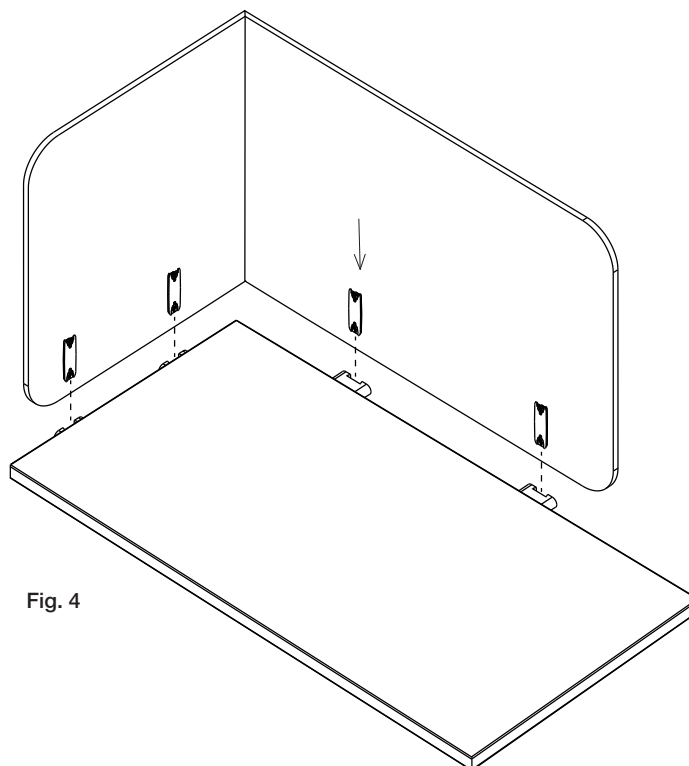

PET Screens with Premium Edgemount Brackets Installation, continued

7. Install the Cap (I) into the recess atop each bracket (Fig. 5).

Fig. 5

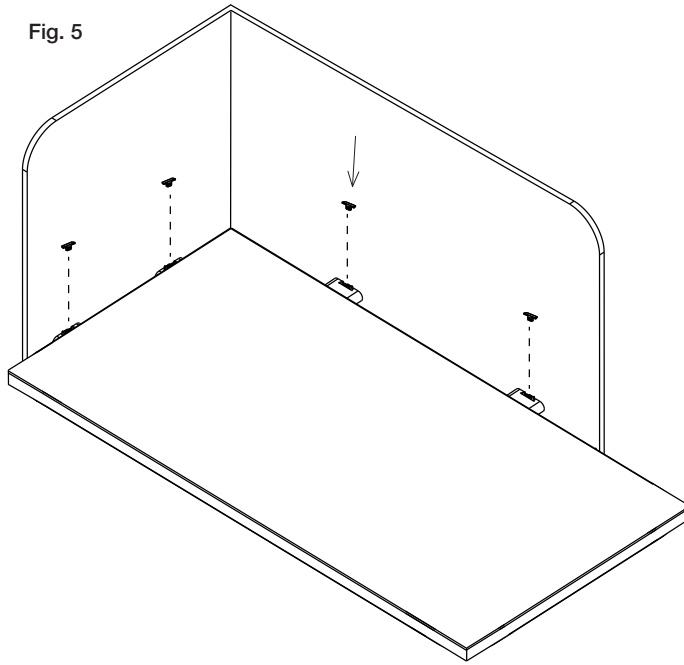
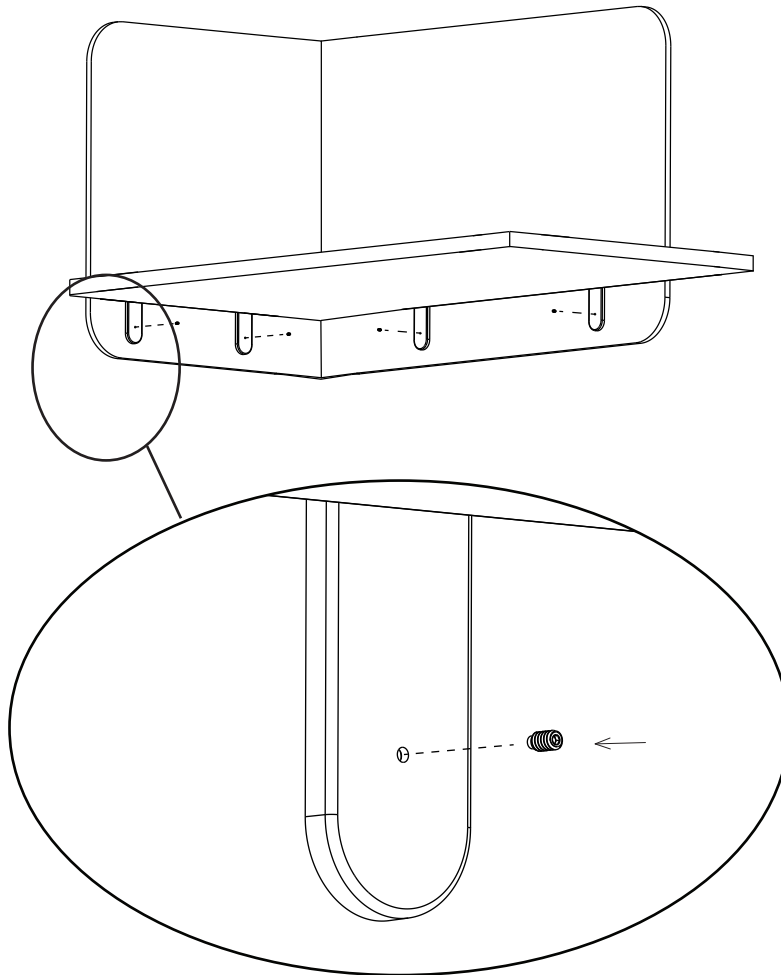

Fig. 6







8. Install (1) 6-32 x 1/4" Extended Tip Set Screw (G) within each Desk Bracket (C/D), below the worksurface, to secure the screen's position.

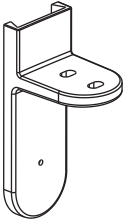
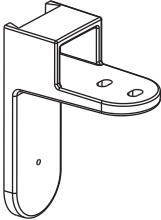

k. screen Contour in PET Installation

All PET Screens with Premium Undermount Brackets, KSUJPU__KSULPU__KSJPU__KSLPU__

Parts List

| | | | | | | | |
|--|---|---|---|---|---|---|---|
|  |  |  |  |  |  |  |  |
| Outer Bracket (A) 3AJ4252 | Inner Bracket (B) 3AJ4299 | 3/8" Side Bracket (C) 3AJ4251 | 1 1/4" Back Bracket (D) 3AJ4250 | 8-32 x 3/8" Truss Head Machine Screw (E) 3AJ4303 | #10 x 1" Type 17 Flat Head (F) 3AJ4288 | 6-32 x 1/4" Set Screw with extended tip (G) 3AB1623 | Cap (H) 3AJ4300 |

Tools Needed:
Tape Measure and pencil
Power Driver with #2 Phillips Bit
#2 Phillips Screwdriver
1/16" Allen Wrench

Premium Undermount Installation

1. Review the dealer-supplied installation documents to identify the size and placement of the k. screen to be attached to the worksurface. Match the size and configuration (Radiused Surround, Rectangular Surround, J-Shape or L-Shape) to the appropriate Installation Appendix A table to determine the positions of required bracket locations.

2. Mark the underside of the top for each bracket location. Ensure the mark extends at least 1-1/2" from the edge. Mark screw locations at each bracket location mark 5/8" and 1-3/8" from the edge (Fig. 1)

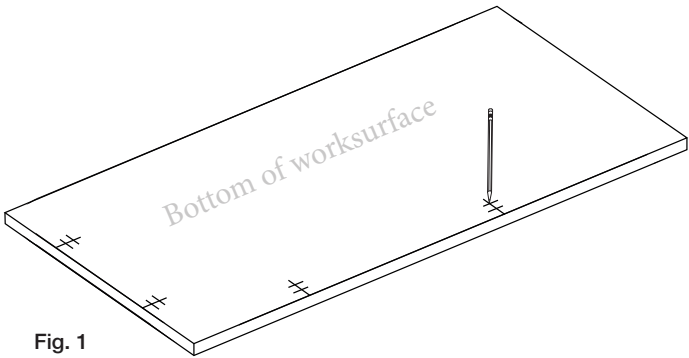

Fig. 1

Attach Brackets to Top

3. Note the difference in thickness between the 1 1/4" Back Brackets (D) and the 3/8" Side Brackets (C). Position, in the quantity required, the 1 1/4" Back Brackets (D) along the back edge of the worksurface to align with the mark made in previous step. Holding the bracket firmly against the edge of the top, with the location mark centered in the bracket slot, attach each bracket to the worksurface using (2) #10 x 1" Type 17 Flat Head Screws (F) (Fig. 2).

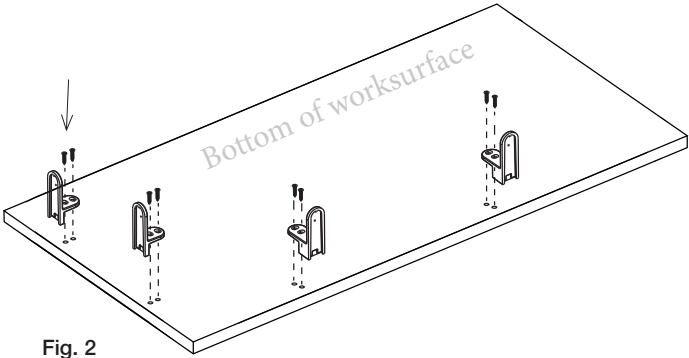

Fig. 2

PET Screens with Premium Undermount Brackets Installation, continued

Panel Preparation

4. On the exterior of the PET panel, Insert an Outer Bracket (A) into each rectangular bracket slot (Fig. 3).

Warning: Do not use impact driver to tighten machine screws in Step 5.

5. On the interior side of the PET panel, attach an Inner Bracket (B) to the Outer Bracket at each location using (2) #8-32 x 3/8" Truss Head Screws (E) (Fig. 3).

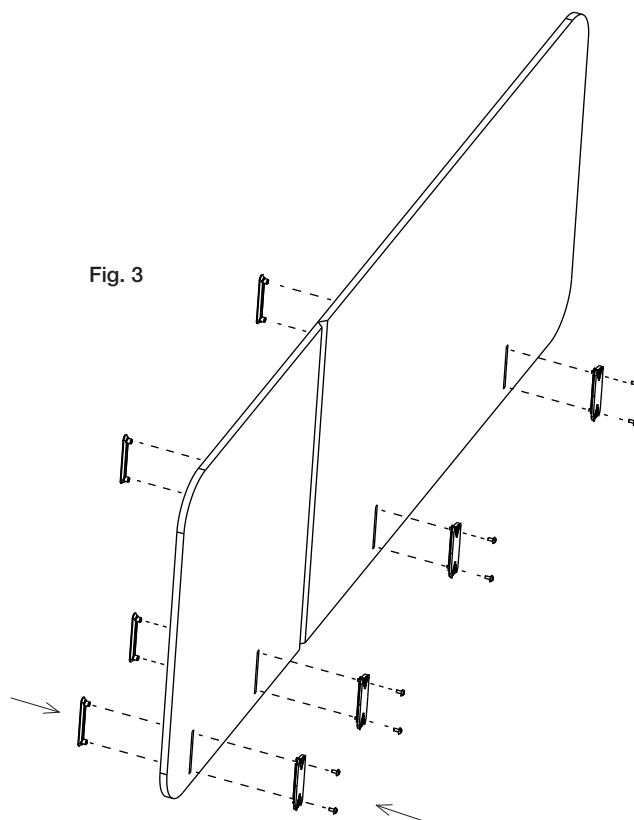

Attach Panel to the Top

6. Connect the screen to the Desk Brackets (C/D), by sliding the Inner Brackets (B) down, vertically, into the desk brackets. All of the brackets will need to be guided down at the same time. The holes in the Side and Back Brackets are elongated to allow side-to-side adjustment and to ensure Inner Brackets can be fully seated; adjust as needed (Fig. 4).

Fig. 4

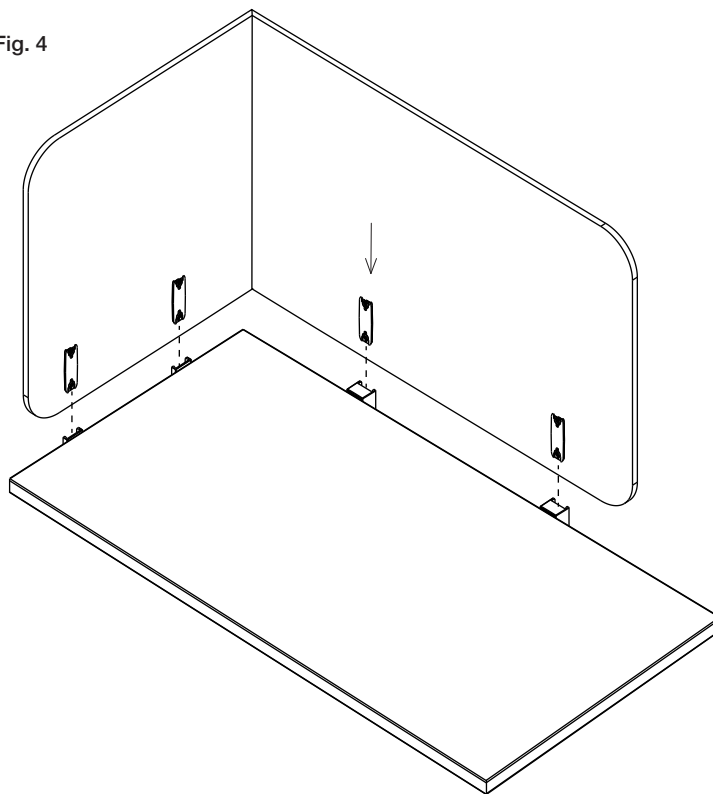

PET Screens with Premium Undermount Brackets Installation, continued

7. Install the Cap (H) into the recess atop each bracket (Fig. 5).

Fig. 5

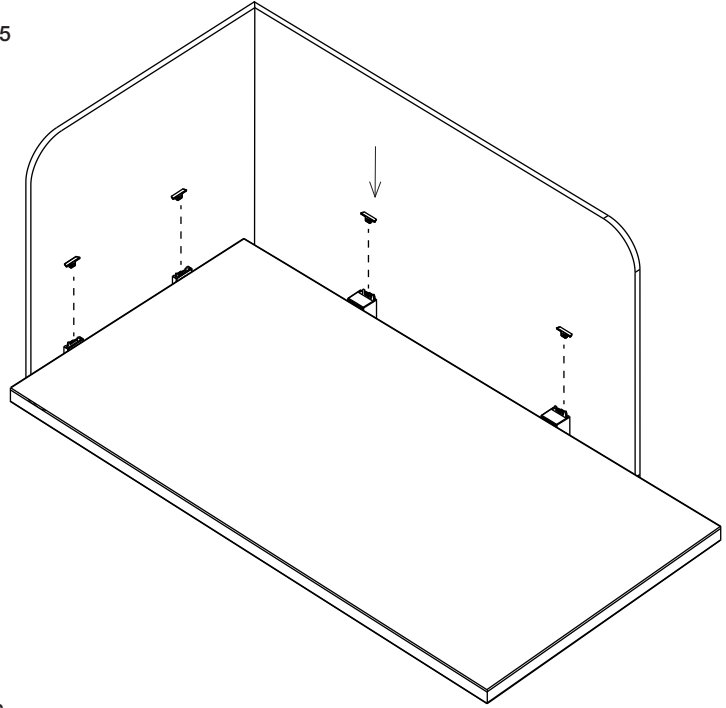

8. Install (1) 6-32 x 1/4" Extended Tip Set Screw (G) within each Desk Bracket (C/D), below the worksurface, to secure the screen's position (Fig. 6).

Fig. 6

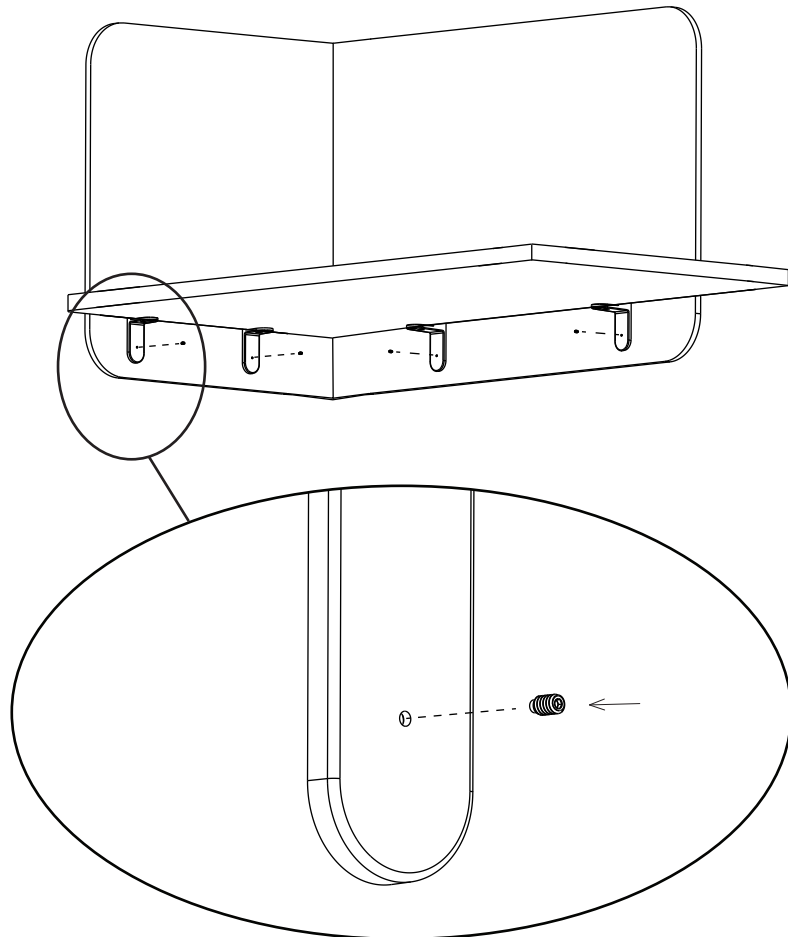

k. screen Contour in PET Installation

All PET Screens with Premium Clampmount Brackets, KSUJPC__KSULPC__KSJPC__KSLPC__

Parts List



Outer
Bracket (A)
3AJ4252



Inner Bracket (B)
3AJ4299

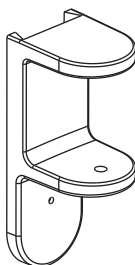

3/8" Side Bracket (C)
3AJ4253

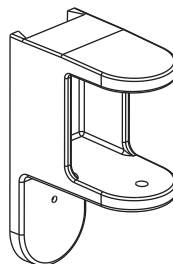

1 1/4" Back Bracket (D)
3AJ4254



Thumb Screw (E)
3AJ4256



Rubber Pad (J)
3AJ1256



8-32 x 3/8" Truss
Head Machine
Screw (F)
3AJ4303



6-32 x 1/4" Set Screw
with extended tip (H)
3AB1623



Cap (I) 3AJ4300



Platen (K)
3AJ4255

Tools Needed:

#2 Phillips Screwdriver
1/16" Allen Wrench

Premium Clampmount Installation

Bracket Preparation

1. Adhere (1) rubber pad (J) to the underside of top flange of each clamp bracket (C/D) (Fig. 1).

2. Install a thumb screw (E) into the bottom flange of each clamp bracket (C/D), allow tip of thumb screw to project past upper surface of bottom flange by at least 1/4". Tip: You can speed up installation if you tailor this thumb screw projection distance for the top thickness. (Fig. 2)

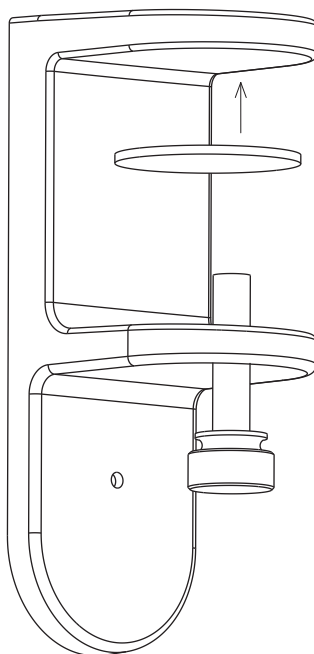

Fig. 1

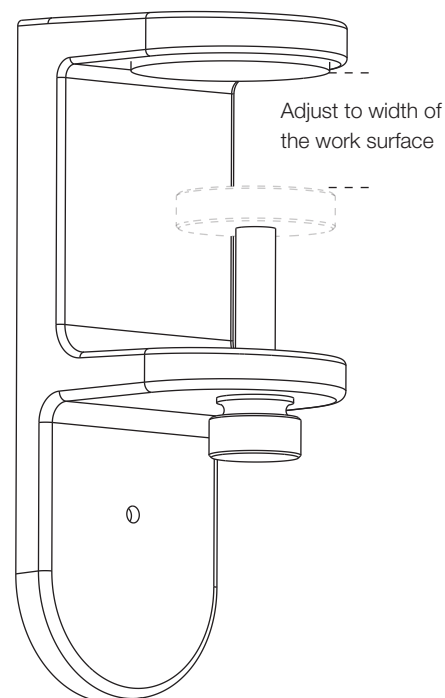

Fig. 2

PET Screens with Premium Clampmount Brackets Installation, Continued

Panel Preparation

3. On the exterior of the PET panel, Insert an Outer Bracket (A) into each rectangular bracket slot.

Warning: Do not use impact driver to tighten machine screws in Step 4.

4. On the interior side of the PET panel, attach an inner bracket (B) to the Outer Bracket at each location using (2) #8-32 x 3/8" Truss Head Screws (F) (Fig. 3).

5. Note difference in thickness between the 1 1/4" Back Brackets (D) and the 3/8" Side Brackets (C). Connect Back Brackets (D) to the back, and Side Brackets to the side(s) of the screen panel by sliding the Brackets (C/D) onto an inner brackets (B) on the inner faces of the panel (Fig. 4).

6. Install (1) 6-32 x 1/4" Extended Tip Set Screw (H) within each Desk Bracket (C/D), below the workspace, to secure the screen's position (Fig. 5).

Fig. 3

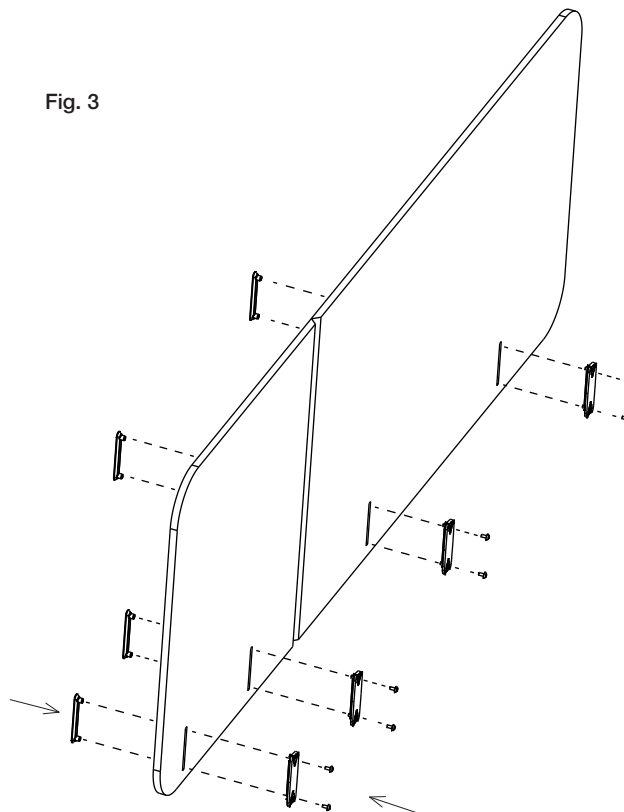

Fig. 5

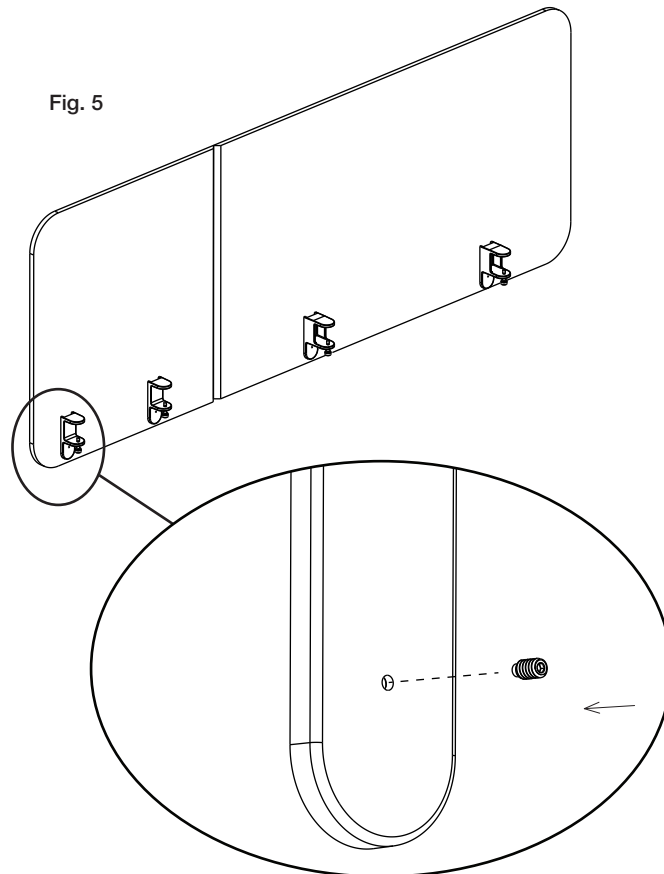
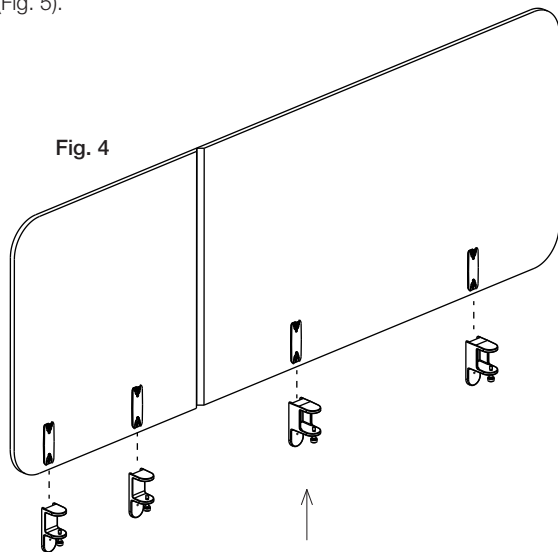

Fig. 4



PET Screens with Premium Clampmount Brackets Installation, Continued

Attach Panel to the Top

7. With all the clamp brackets (C/D) attached to the panel, place the panel onto the worksurface by resting the top flange of each clamp bracket atop the worksurface (Fig. 6).

Fig. 6

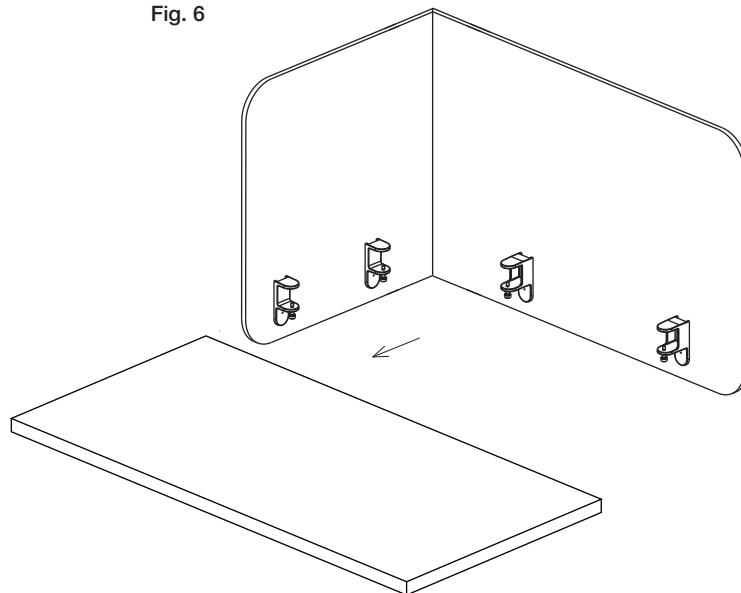

8. Insert a platen (K) atop each thumbscrew and lightly tighten the thumbscrew, securing the screen to the top (Fig. 7).

9. Adjust the clamp (C/D) locations on the top per dimensions in the appropriate Table in Appendix A. Fully tighten all thumbscrews.

10. Install the Cap (I) into the recess atop each bracket (Fig. 8).

Fig. 7

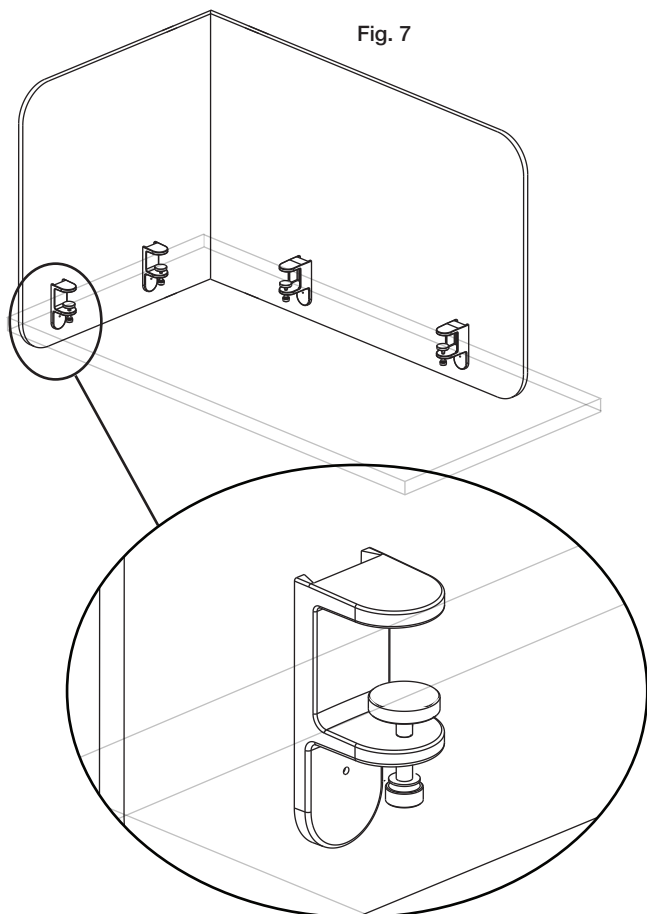
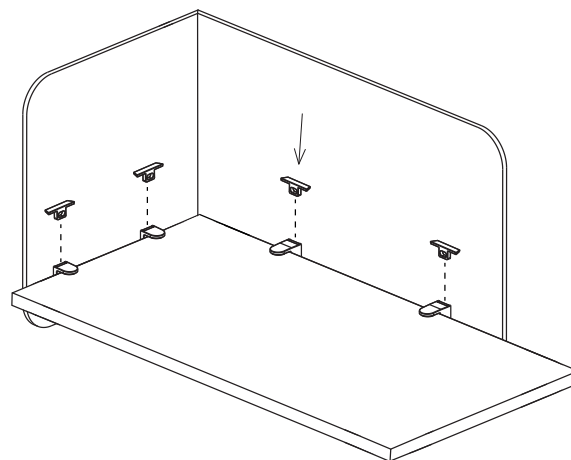

Fig. 8



k. screen Contour in PET Installation : Appendix A

Bracket Locations:

(From Edge to Centerline of Bracket)

| L-Shape Screens and J-Shape Screens | | | | | |
|-------------------------------------|----------------------------------|------|------|-----------------------------------|------|
| | Back | | | Side | |
| Screen Width | Dimension(Inches) from Side Edge | | | Dimension (Inches) from Back Edge | |
| | Near | 2nd | 3rd | Near | 2nd |
| 42 | 10.5 | 31.5 | | 6 | 16.5 |
| 48 | | 37.5 | | | |
| 54 | | 43.5 | | | |
| 60 | | 49.5 | | | |
| 66 | | 33 | 55.5 | | |

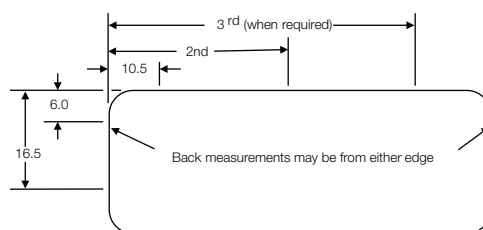
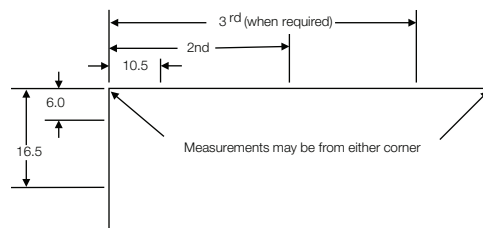

| Rectangular Surround Screens | | | | | |
|------------------------------|----------------------------------|-------|------|-----------------------------------|-------|
| | Back | | | Side | |
| Top Width | Dimension(Inches) from Side Edge | | | Dimension (Inches) from Back Edge | |
| | Near | 2nd | 3rd | Near | 2nd |
| 45 | 10.5 | 34.5 | | 6 | 16.5 |
| 46 | | 35.5 | | | |
| 51 | | 40.5 | | | |
| 52 | | 41.5 | | | |
| 57 | | 46.5 | | | |
| 58 | | 47.5 | | | |
| 63 | | 31.5 | 52.5 | | |
| 64 | | 32 | 53.5 | | |
| 69 | | 34.50 | 58.5 | | |
| 70 | | 35 | 59.5 | | |
| 75 | | 37.5 | 64.5 | | 15.75 |
| 76 | | 38 | 65.5 | | 15.25 |

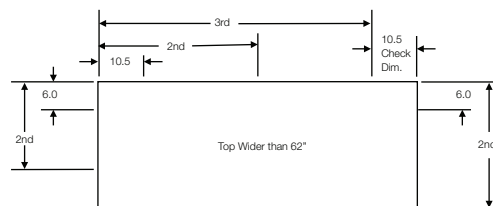
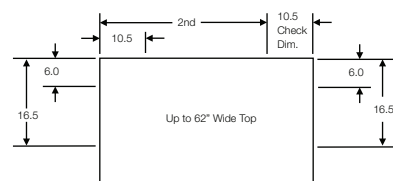

k. screen Contour in PET Installation: Appendix A, continued

Bracket Locations:

(From Edge to Centerline of Bracket)

| Radiused Surround Screens | | | | | |
|---------------------------|---|------|-----|-----------------------------------|-----|
| | For Antenna Radius Corner HAT tops, or other 3" Radius Corner tops that measure 45, 51, 57, 63, 69, or 75 inches wide. (W-3") | | | | |
| | Back | | | Side | |
| Top Width | Dimension(Inches) from Side Edge | | | Dimension (Inches) from Back Edge | |
| | Near | 2nd | 3rd | Near | 2nd |
| 45 | 10 | 35 | 6.5 | 17 | 17 |
| 51 | | 41 | | | |
| 57 | | 47 | | | |
| 63 | | 31.5 | | | |
| 69 | | 34.5 | | | |
| 75 | | 37.5 | | | |

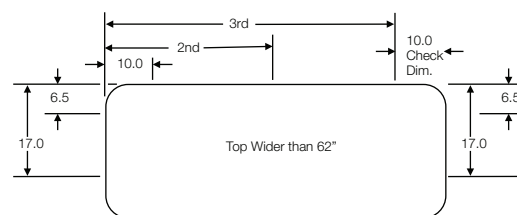
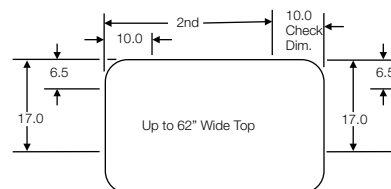

| Radiused Surround Screens | | | | | |
|---------------------------|--|------|-----|-----------------------------------|------|
| | For Dividends and Refr Radius Corner HAT tops, or other 3" Radius Corner tops that measure 46, 52, 58, 64, 70, or 76 inches wide. (W-2") | | | | |
| | Back | | | Side | |
| Top Width | Dimension(Inches) from Side Edge | | | Dimension (Inches) from Back Edge | |
| | Near | 2nd | 3rd | Near | 2nd |
| 46 | 10.5 | 35.5 | 6 | 16.5 | 16.5 |
| 52 | | 41.5 | | | |
| 58 | | 47.5 | | | |
| 64 | | 32 | | | |
| 70 | | 35 | | | |
| 76 | | 38 | | | |

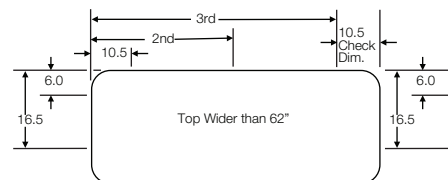
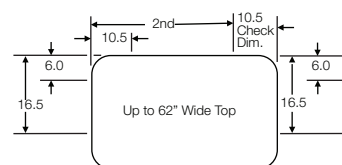

k. screen Contour in PET Installation: Appendix A, continued

Bracket Locations:

(From Edge to Centerline of Bracket)

| Radiused Surround Screens | | | | | |
|---------------------------|--|------|-----|-----------------------------------|---------|
| | For Benching HAT tops used on HAT Bases, or other 3" Radius Corner tops that measure 47, 53, 59, 65, 71, or 77 inches wide. (W-1") | | | | |
| | Back | | | Side | |
| Top Width | Dimension(Inches) from Side Edge | | | Dimension (Inches) from Back Edge | |
| | Near | 2nd | 3rd | Near | 2nd |
| 47 | 11 | 36 | | 5 9/16 | 16 1/16 |
| 53 | | 42 | | | |
| 59 | | 48 | | | |
| 65 | | 32.5 | | | |
| 71 | | 35.5 | | | |
| 77 | | 38.5 | | | |

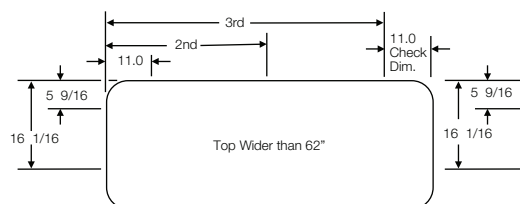
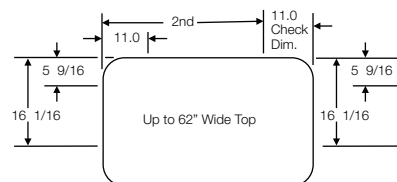

| Radiused Surround Screens | | | | | |
|---------------------------|--|------|-----|-----------------------------------|--------|
| | For Full Width Radius Corner HAT tops, or other 3" Radius Corner tops that measure 48, 54, 60, 66, 72, or 78 inches wide. (W-0") | | | | |
| | Back | | | Side | |
| Top Width | Dimension(Inches) from Side Edge | | | Dimension (Inches) from Back Edge | |
| | Near | 2nd | 3rd | Near | 2nd |
| 48 | 11.5 | 36.5 | | 5 1/8 | 15 5/8 |
| 54 | | 42.5 | | | |
| 60 | | 48.5 | | | |
| 66 | | 33 | | | |
| 72 | | 36 | | | |
| 78 | | 39 | | | |

